

36 31
TWP. COR.
FD. BR. DISK
IN MON. CASE

E. VILAS RD. S 89°43'30" E 2523.92'
2352.90' (DEED & MEASURED)

1/4 CORNER
FD. 3/4" G.I. PIPE /
2" BRASS CAP FLUSH
WITH PAVEMENT
(SEE FILED SURVEY
NO. 10804)

**SURVEY FOR
ACTION AUTO WRECKING**

984 VILAS ROAD
MEDFORD, OREGON
LOCATED IN THE NW 1/4 OF
SECTION 6, T37S, R.1W, W.M.
JACKSON COUNTY, OREGON

MARCH 4, 1987



SCALE: 1" = 100'

BASIS OF BEARINGS
FILED SURVEY NO. 10804

LEGEND
• SET 5/8" x 24" REBAR
WITH PLASTIC CAP MARKED
"KAISER RLS 803"

**** RECEIVED ****
Date 3/4/87 By JK
This survey consists of:
— 1 sheet(s) Map
— 2 page(s) Narrative
JACKSON COUNTY
SURVEYOR

SURVEY BY
BOYDEN SURVEYORS
108 MISTLETOE ST.
MEDFORD, OREGON

REGISTERED
PROFESSIONAL
LAND SURVEYOR

Gary D. Kaiser
OREGON
JULY 16, 1967
GARY D. KAISER
No 803

INST. NO.
82-09305 O.R.

S 0°05'17"E (REC. = S 0°05' E)
1285.76'

N 0°05'30" W 1285.32'

NORTH-SOUTH & SECTION 6
S 0°05' E

WESTERLY BOUNDARY OF THE FORMER
60' WIDE MEDFORD AND CRATER LAKE RAILROAD CO.
RIGHT-OF-WAY (VOL. 59, PAGE 535 D.R.) PER FILED SURVEY NO. 832

NOTE: RAILROAD TRACKS ARE NO LONGER EXISTING,
BEING REPLACED BY MEDFORD CORPORATION'S
PRIVATE HAUL ROAD

CTR. R.R. VID.
IRR. LATERAL

SOUTH BNDRY. OF THE NE 1/4
OF THE NW 1/4 OF SEC. 6 PER
FILED SURVEY NO. 9870

WIT. COR.

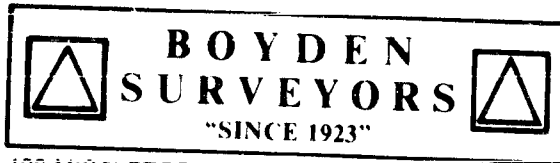

MARK E. BOYDEN
R.P.L.S. ORE 281

108 MISTLETOE ST., MEDFORD, OREGON 97501
PHONE (503) 773-6000

GARY D. KAISER
R.P.L.S. ORE 663

SURVEY NO. 10816

SURVEY NARRATIVE TO COMPLY WITH O.P.S. 209.250

SURVEY FOR: ACTION AUTO WRECKING
984 Vilas Road
Medford, Oregon, 97504

SURVEY BY: BOYDEN SURVEYORS
108 Mistletoe St.
Medford, Oregon, 97501

DATE: March 4, 1987

LOCATION: NW 1/4 of Section 6, Township 37 South,
Range 1 West of the Willamette Meridian
in Jackson County, Oregon.

BASIS OF BEARINGS: Filed Survey No. 10804

PURPOSE: To monument the exterior corners, or
witness corners, the tracts described in
Instrument No. 85-07582 and in Instrument
No. 85-08498 of the Official Records of
Jackson County, Oregon.

PROCEDURE:

Utilizing controls established on Filed Survey No. 10804 and the Subdivision of Section 6 data reported on Filed Survey No. 9870, enclosed the subject property with E.D.M. equipment.

The deed distances beginning at the Northwest corner of Section 6 agree within themselves for the subject parcels and were utilized for control of the Westerly property line. The Easting of this position checked favorably with the fence corner near the Northwest corner of the subject tract.

The Westerly property boundary was established on the bearing of the West boundary of the East-half of the Northeast Quarter of the Northwest Quarter of said Section 6, as calculated from the data of Filed Survey No. 9870. This procedure was considered to be the intent of the original partitioner, L.M. Mayes.

The East boundary of the subject premises (being the "North-South" centerline of Section 6) was monumented with witness corners located on the Old Westerly railroad right-of-way boundary.

It should be noted that the railroad Deed Volume 59, Page 535 had a reversionary clause stating "The land to revert to the owner if not used for the Railroad right-of-way". The exact ownership of this land within the Old railroad right-of-way, since this right-of-way is presently utilized as a private haul road, has not been definitely explored at this writing. From said data, monumented the parcels at positions shown on the map to accompany this report.

**** RECEIVED ****
Date 3/4/87 By JK
This survey Consists of:
1 sheet(s) Map
2 page(s) Narrative
JACKSON COUNTY
SURVEYOR

REGISTERED
PROFESSIONAL
LAND SURVEYOR

Gary D. Kaiser

OREGON
JULY 16, 1967
GARY D. KAISER
No 803

TAX LOTS 300 & 500

S6 T371W