

10729

SURVEY FOR: CALIFORNIA OREGON BROADCAST INVESTMENTS
 LOCATED IN THE S. E. 1/4 OF SECTION 32, T.37S., R.1W., W.M.
 MEDFORD, OREGON
 OCT. 29, 1986

FILED SURVEY
 NOS. 8956 & 2671

Found 3/4" re-bar (Filed Survey No. 2671) South 1901.53' and West 421.39' from the E.S.E. Corner of D.L.C. No. 51.

Record: $R=14022.00'$, $L=120.00'$, $\Delta=454.00'$
 $S=255^{\circ}09'10.0"$, $E=114.91'$

SCALE: 1" = 20'
 BASIS OF BEARINGS:
 FILED SURVEY NO. 2671

Monument set on Filed Survey No. 2671 destroyed by street construction. Found 3/8" re-bar with plastic cap set on a survey in progress not yet recorded. WHICH BEARS NORTH, 0.12' AND

Easement P.O.B. EAST, 0.28'

Found 5/8" re-bar with plastic cap. (Filed Survey No. 8956)

- LEGEND
- Found monument as indicated
 - Set 5/8" x 24" re-bar (except as noted) with plastic cap marked "BOYDEN R.L.S. 281."

SURVEY BY: BOYDEN SURVEYORS
 108 Mistletoe St.
 Medford, Oregon

** RECEIVED **
 Date 11/14/86 By SK
 This survey consists of:
1 sheet(s) Map
2 page(s) Narrative
 JACKSON COUNTY
 SURVEYOR

REGISTERED
 PROFESSIONAL
 LAND SURVEYOR
Mark E. Boyden
 OREGON
 NOV. 9 1951
 MARK E. BOYDEN
 281

371W 32D 10729

10729

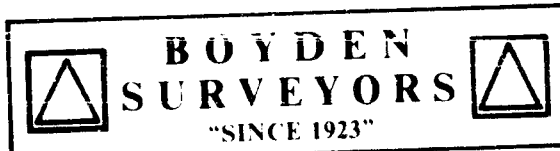

MARK E. BOYDEN
RPLS ORE 281

108 MISTLETOE ST., MEDFORD, OREGON 97501
PHONE (503) 773-6000

GARY D. KAISER
RPLS ORE 603

PAGE 1, of 2

SURVEY NO. _____

SURVEY NARRATIVE TO COMPLY WITH O.R.S. 209.250

SURVEY FOR: CALIFORNIA OREGON BROADCASTING INVESTMENTS
c/o Carl M. Brophy, Atty.
201 West Main Street
Medford, Oregon, 97501

SURVEY BY: BOYDEN SURVEYORS
108 Mistletoe Street
Medford, Oregon, 97501

LOCATION: SE 1/4 of Section 32, Township 37 South,
Range 1 West of the Willamette Meridian.
City of Medford, Jackson County, Oregon.

BASIS OF BEARINGS: Filed Survey No. 2671

TAX LOT NUMBER: 37 1W 32D 600

DATE: October 29, 1986

PURPOSE:

- 1.) To monument the 'as built' pavement centerline of a proposed perpetual exclusive access easement and describe the exterior boundaries of said easement at the approximate 'Top of Slope' for conveyance purposes to California Oregon Broadcasting Investments.
- 2.) To locate and describe (but not monument), a perpetual non-exclusive access easement from aforesaid exclusive access easement, along Skyline Drive and Mira Mar Avenue (both private roads) to the intersection of the City streets at the Mira Mar Avenue and Shannon Drive intersection, also for conveyance purposes to California Oregon Broadcasting Investments.

PROCEDURE:

From control monuments previously utilized on Filed Survey No.s 2671 and 8956, monumented and described the perpetual exclusive access easement as shown on the annexed map.

For the location of the aforesaid perpetual non-exclusive access easement boundaries, points in back of the existing curbs

were utilized to facilitate easement boundaries that would generally include the existing pavement and curbs on aforesaid streets. Said non-exclusive easement also fronts on the Northeasterly boundaries of the City of Medford reservoir tract (see Volume 460 Deeds, Page 373) and the California Oregon Broadcasting Investments property (see Volume 590 Deeds, Page 207).

**** RECEIVED ****
Date 11/14/86 By SK
This survey Consists of:
1 sheet(s) Map
2 page(s) Narrative
JACKSON COUNTY
SURVEYOR

REGISTERED
PROFESSIONAL
LAND SURVEYOR
Mark E. Boyden
OREGON
NOV. 9, 1951
MARK E. BOYDEN
281