

SURVEY NARRATIVE TO COMPLY WITH
PARAGRAPH 209.250 OREGON REVISED STATUTES

SURVEY FOR: Rogue River National Forest
P. O. Box 520
Medford, OR 97501

LOCATION: Section 30, Township 32 South, Range 4 East,
Willamette Meridian, Jackson County, Oregon.

PURPOSE: To preserve and protect deteriorating corner evi-
dence.

PROCEDURE: Utilizing existing corner evidence recovered at
each corner point, I verified the corner point from
recovered accessories, stabilized the monument as
needed and marked additional accessories as
required to perpetuate the corner point.

BASIS OF BEARING: Record Survey No. 8596. (Var. 19°30'E.)

12 January, 1986

HAROLD L. CENTER
Registered Professional Land Surveyor
Oregon Certificate No. 1071

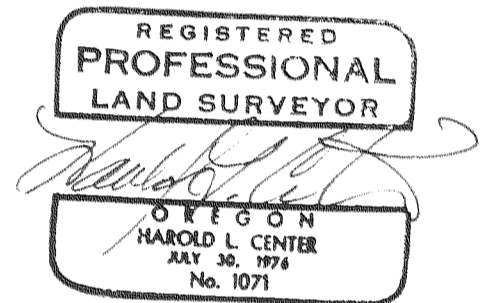
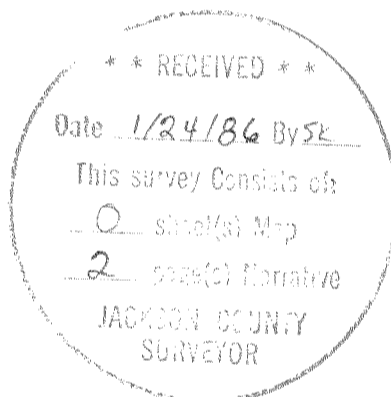

CERTIFIED RECORD OF LAND CORNER MONUMENTATION

History of original corner establishment:

The center-west one-sixteenth corner for Section 30, Township 32 South, Range 4 East, Willamette Meridian, Jackson County, Oregon, was established by Donald L. Branch (P.L.S. #1137) during Record Survey No. 8596 dated 21 October, 1980.

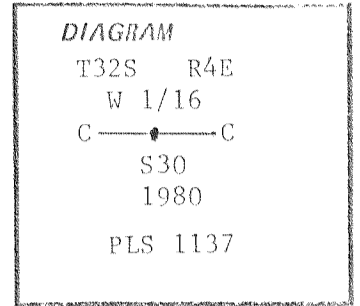

Description of corner evidence found:

Found a 2 1/2-inch diameter brass cap monument marked as shown in diagram, and the following accessories:

A 22-inch diameter fir bears N.78°15' E., 37.5 feet distance, with scribing visible on a partly healed blaze. (Note: This accessory was used as basis of bearing...var. 19°30'E.)

A 15-inch diameter hemlock bears S.21°00'W., 5.3 feet distance, with CW 1/16 S30 BT visible. This tree now dead.

Description of monument and accessories established to perpetuate the original location of this corner:

I mark a new accessory as follows:

A 31-inch diameter fir bears N.57°30'W., 63.9 feet distance, scribed CW 1/16 S30 LS1071 BT.

Trees are marked with a 6-inch wide band of red paint and Forest Service signs are attached.

12 January, 1986

HAROLD L. CENTER
Registered Professional Land Surveyor
Oregon Certificate No. 1071

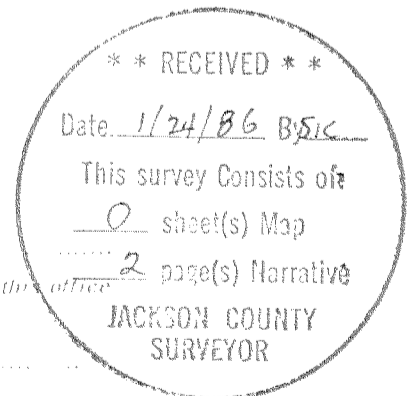

Office of... County of... State of... I hereby certify that the within instrument was filed in the office for record on the... day of... 19... by... COUNTY OFFICIAL... DEPUTY