

OREGON STATE PARKS & RECREATION DIVISION SURVEY
JOSEPH STEWART STATE PARK
SECTIONS 20, 29, & 30, T. 33 S., R. 2 E., W.M.
JACKSON COUNTY
SCALE: 1" = 500'
DECEMBER 21, 1984

REGISTERED
PROFESSIONAL
LAND SURVEYOR

John E. Hollingsworth

OREGON
JULY 9, 1965
JOHN E. HOLLINGSWORTH
691

**** RECEIVED ****
Date: 1/25/85 By sc
This survey consists of:
1 sheet(s) Map
1 page(s) Narrative
JACKSON COUNTY
SURVEYOR

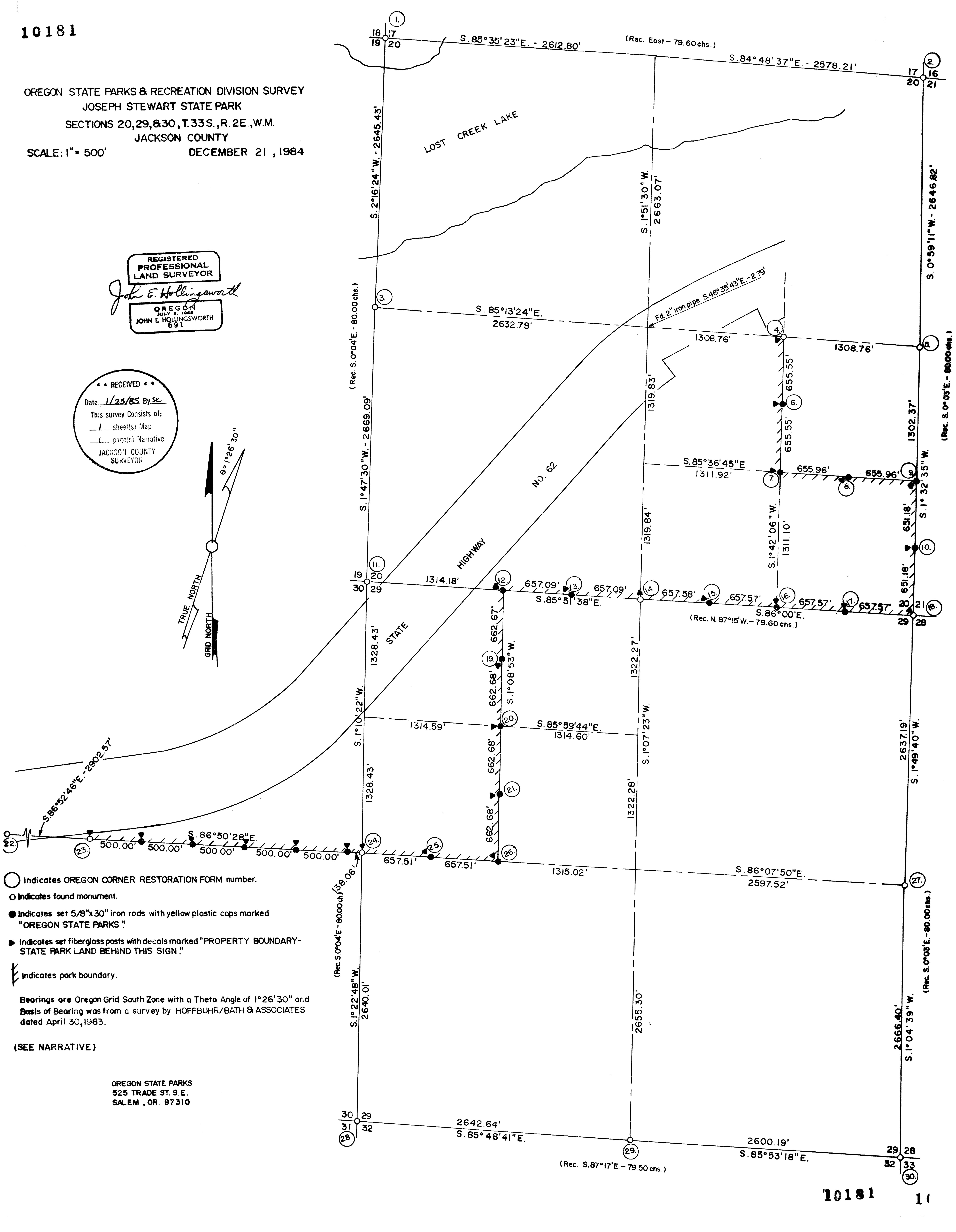
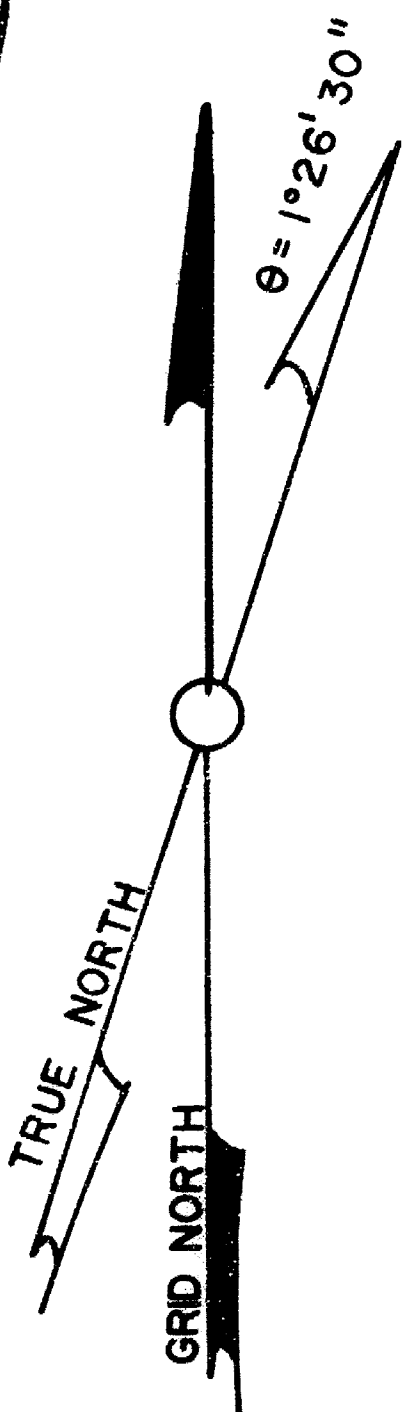

- Indicates OREGON CORNER RESTORATION FORM number.
- Indicates found monument.
- Indicates set 5/8"x30" iron rods with yellow plastic caps marked "OREGON STATE PARKS"
- Indicates set fiberglass posts with decals marked "PROPERTY BOUNDARY- STATE PARK LAND BEHIND THIS SIGN."
- ▬▬▬ Indicates park boundary.

Bearings are Oregon Grid South Zone with a Theta Angle of 1°26'30" and Basis of Bearing was from a survey by HOFFBUHR/BATH & ASSOCIATES dated April 30, 1983.

(SEE NARRATIVE)

OREGON STATE PARKS
525 TRADE ST. S.E.
SALEM, OR. 97310

OREGON CORNER RESTORATION FORM

Section 29 Township 33S Range 2E

County Jackson Date June 6, 1984

Corner Designation

Section Corner

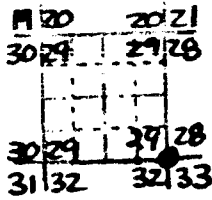

- Condition Report Only
- Not Found
- Renewed
- Unrecorded
- Surveyed In
- Referenced Out

Previous Renewals/Surveys, etc. BLM 1966

Monument(s) & Accessories Found: (Condition and Source)

Found 10" diameter Douglas fir, N11°E, 11.1', visible blaze. Found 14" diameter Douglas fir, N19°W, 24.9', visible blaze. Found 16" diameter Douglas fir, N63°E, 30.9', visible blaze. Found 16" diameter Douglas fir, S26°E, 13.6', visible blaze. Found 14" diameter Douglas fir, S3°E, 20.0', visible blaze. Found 10" diameter white fir, S36°W, 10.0', visible blaze. Found 14" diameter Douglas fir, S47°W, 29.1', visible blaze. Found 4' diameter Douglas fir stump, S60°W, 29.6', visible blaze. Found 13" diameter white fir, N68°W, 10.1', visible blaze. Found 3" BLM brass cap on iron pipe.

NOTE: All BT's have metal BLM BT tags.

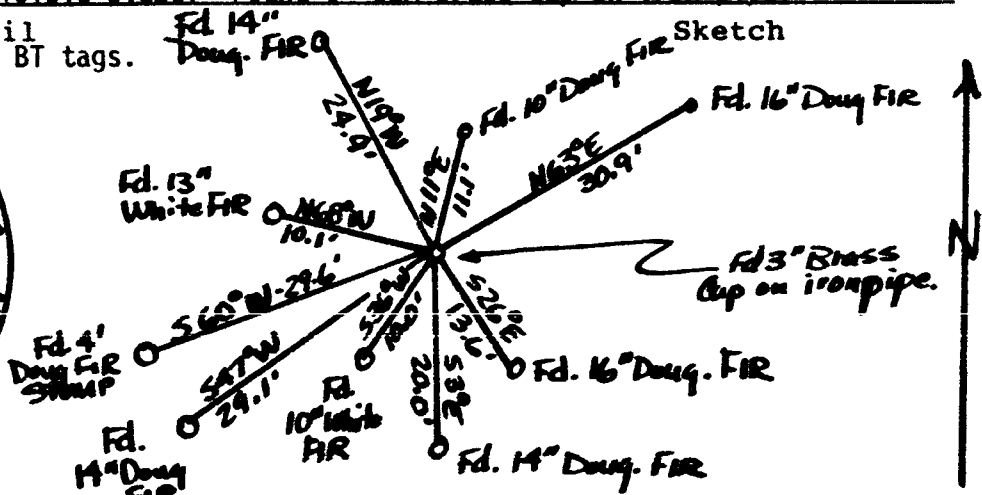
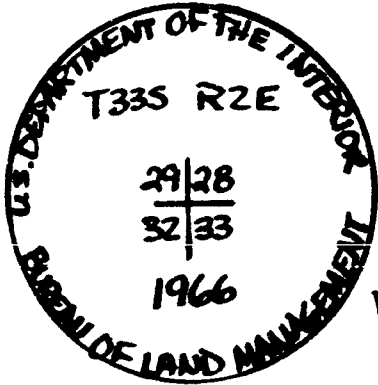

Monument Set (Procedures and Description)

New Accessories

Location & Comments

Stewart State Park
All bearings by hand
compass and steel tape.
Drawing not to scale.

Compass Declination 20.0°E
 Firm/Agency Oregon State Parks & Recreation Div.
 Address 525 Trade St. SE Salem OR 93710
 Party Chief Craig Holt
 Notes Craig Holt
 Witness G. Cottrell, B. Staggs

Surveyor's Seal



OREGON CORNER RESTORATION FORM

Section 29 Township 33S Range 2E

County Jackson Date June 5, 1984

Corner Designation

Quarter Corner

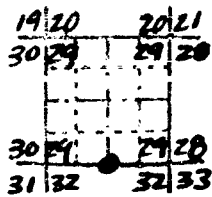

- Condition Report Only
- Not Found
- Renewed
- Unrecorded
- Surveyed In
- Referenced Out

Previous Renewals/Surveys, etc.

None Available

Monument(s) & Accessories Found: (Condition and Source)

Found 1 1/4" iron pipe protruding 0.4' above ground, with a 16"x11"x10" stone with 1/2" chiselled along side.

Found 20" diameter fir, not scribed, with a metal corner tag marked

"S52W, 15 ft." and BLM 3-74, and DAS 4-62, grid N58°23'29"E, 16.3'.

Found original BT, now 3' diameter high stump, 4.5' tall, visible scribing

"4", "S", grid N5°15'29"E, 42.7'.

Monument Detail

Sketch

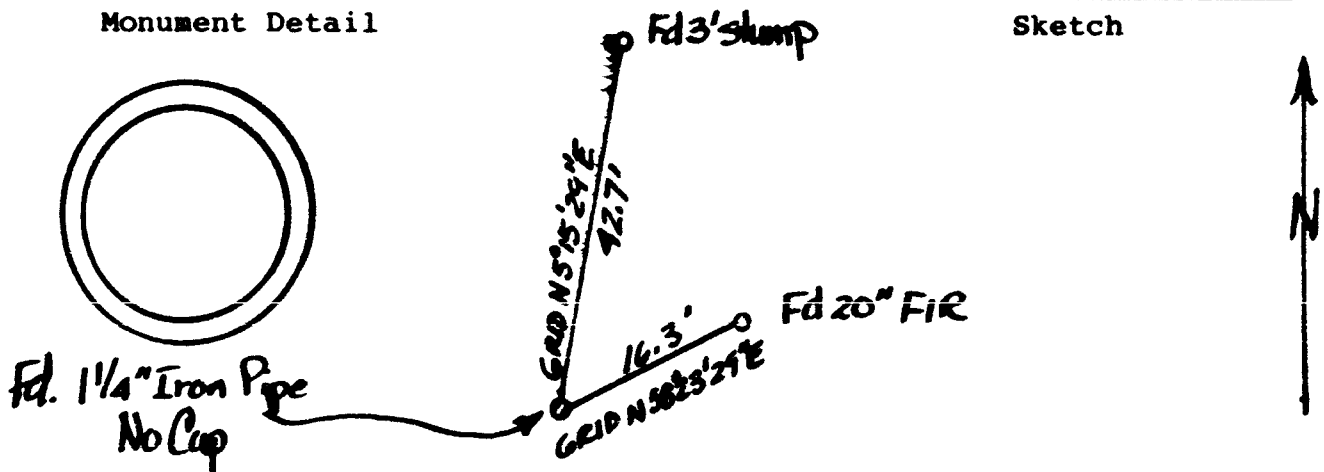

Monument Set (Procedures and Description)

New Accessories

Location & Comments

Surveyor's Seal

Stewart State Park Compass Declination _____
Bearings and distance Firm/Agency Oregon State
by transit and chain. Parks & Recreation Div.
Theta angle of 1°26'30" Address 525 Trade St. SE
to convert to true Salem OR 97310
bearing. Party Chief Craig Holt
 Notes Craig Holt
 Witness G. Cottrell, B. Staggs

REGISTERED
 PROFESSIONAL
 LAND SURVEYOR

John E. Hollingsworth

OREGON
 JULY 8, 1968
 JOHN E. HOLLINGSWORTH
 691

OREGON CORNER RESTORATION FORM

Section 29 Township 33S Range 2E

County Jackson Date June 6, 1984

Corner Designation

Section Corner

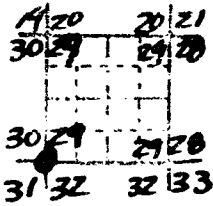

- Condition Report Only
- Not Found
- Renewed
- Unrecorded
- Surveyed In
- Referenced Out

Previous Renewals/Surveys, etc.

BLM 1965

Monument(s) & Accessories Found: (Condition and Source)

Found 3" BLM brass cap on iron pipe in a mound of stones.
 Found 4 1/2' diameter fir stump (rotting), S88°E, 179.8', bark scribed "T33S R2E, S32". Found 50" diameter fir stump, N39°E, 46.6', visible bark scribing, unintelligible. Found 16" diameter fir, N18°E, 64.5', visible blaze. Found 13" diameter fir, N28°W, 54.8', visible blaze. Found 45" diameter fir stump, N39°W, 40.3', no visible blaze or tag. Found 14" diameter fir, S86°W, 48.6', visible blaze. Found 13" diameter fir, S60°E, 42.9', visible blaze. NOTE: All BT's have BLM Yellow metal BT tags.

Monument Detail

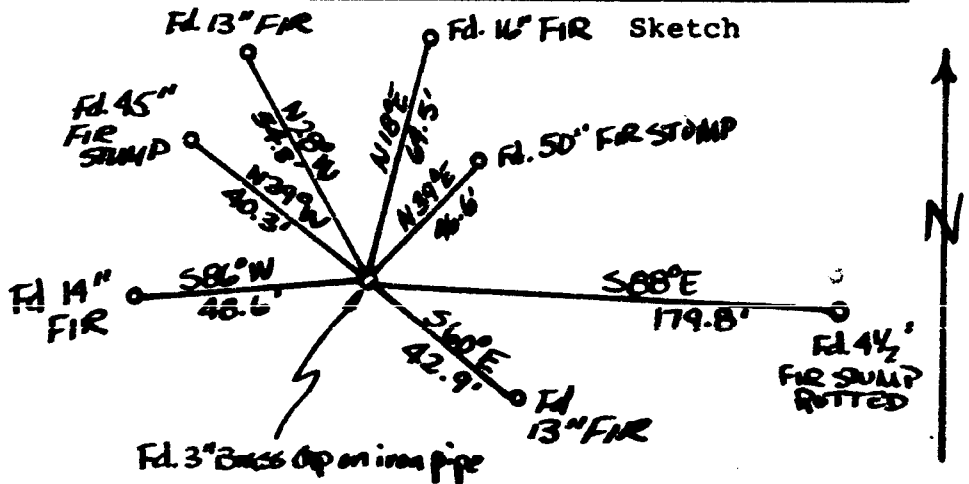

Monument Set (Procedures and Description)

New Accessories

Location & Comments

Stewart State Park
All bearings and distances from hand
compass and steel tape.
Drawing not to scale.

Compass Declination 20° E
 Firm/Agency Oregon State Parks & Recreation Div.
 Address 525 Trade St. SE Salem OR 97310
 Party Chief Craig Holt
 Notes Craig Holt
 Witness G. Cottrell, B. Staggs

Surveyor's Seal

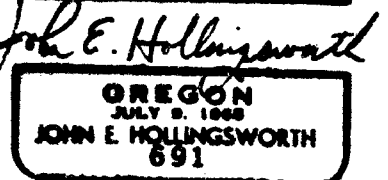
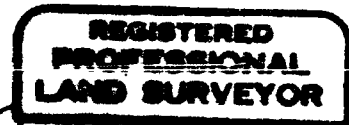

OREGON CORNER RESTORATION FORM

Section 29 Township 33S Range 2E

County Jackson Date June 6, 1984

Corner Designation

Quarter Corner

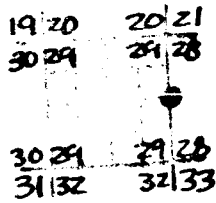

- Condition Report Only
- Not Found
- Renewed
- Unrecorded
- Surveyed In
- Referenced Out

Previous Renewals/Surveys, etc.

BLM 1965

Monument(s) & Accessories Found: (Condition and Source)

Found BLM 3 1/2" brass cap on iron pipe found protruding 0.4' out of ground.

Found 7" diameter fir grid N40° 01' 20" W, 12.3', scribed "1/4 S29BT".

Found 54" diameter fir stump, grid S22° 00' 32" E, 7.2', bark scribed "1/4".

Monument Detail

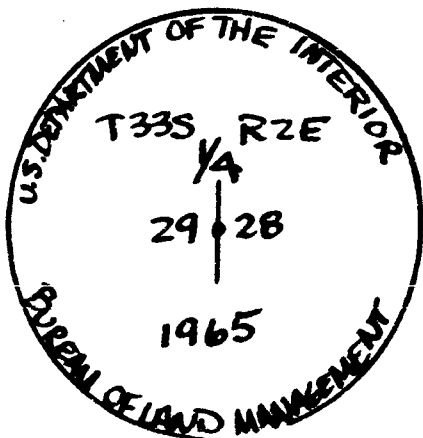

Fd. 7" FIR

Sketch

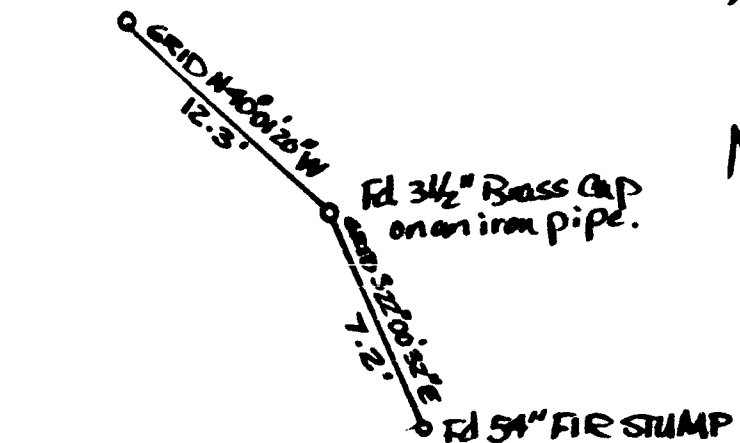

Monument Set (Procedures and Description)

New Accessories

Location & Comments

Stewart State Park
Bearings and distances
by theodolite & steel
tape. Drawing not to
scale. Theta angle of
1° 26' 30" to convert to
true bearings.

Compass Declination
Firm/Agency Oregon State
Parks & Recreation Div.
Address 525 Trade St. SE
Salem OR 97310
Party Chief Craig Holt
Notes Craig Holt
Witness C. Cottrell, B. Staggs

Surveyor's Seal



OREGON CORNER RESTORATION FORM

Section 29 Township 33S Range 2E

County Jackson Date Nov. 8, 1984

Corner Designation

C-W 1/16

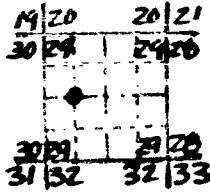

- Condition Report Only
- Not Found
- Renewed
- Unrecorded
- Surveyed In
- Referenced Out

Previous Renewals/Surveys, etc. _____

Monument(s) & Accessories Found: (Condition and Source)

Monument Detail

Sketch

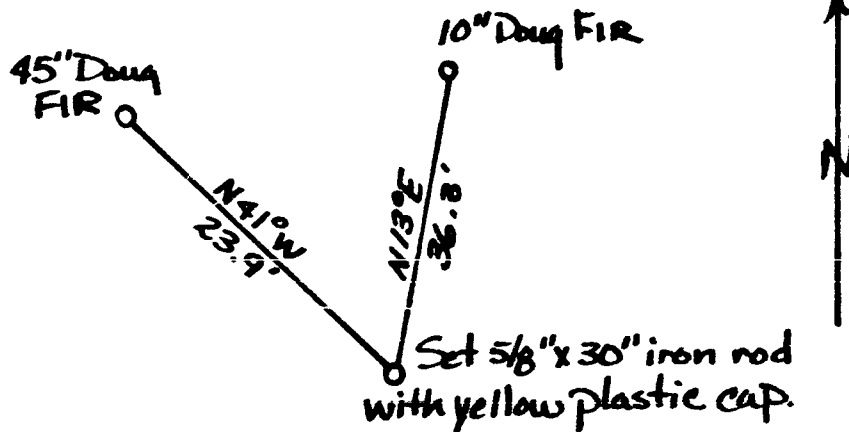
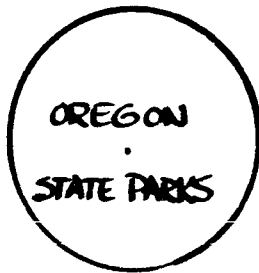

Monument Set (Procedures and Description)

Set 5/8"x30" iron rod with yellow plastic cap marked "OREGON STATE PARKS" in a mound of stones.

New Accessories

10" diameter fir N13°E, 36.3' scribed "CW1/16 S29BTRS691".

45" diameter fir N41°W, 23.9' bark scribed "CW1/16 S29BT".

Set fiberglass post with decal marked "PROPERTY BOUNDARY-STATE PARK LAND BEHIND THIS SIGN" 2.0' northwest.

Location & Comments

Surveyor's Seal

Stewart State Park _____ Compass Declination 20.4°E
 All bearings and _____ Firm/Agency Oregon State
 distances by hand compass _____ Parks & Recreation Div.
 and steel tape. _____ Address 525 Trade St. SE
 Drawing not to scale. _____ Salem OR 97310
 _____ Party Chief Craig Holt
 _____ Notes Craig Holt
 _____ Witness M. Bradetich

REGISTERED PROFESSIONAL LAND SURVEYOR

John E. Hollingsworth

OREGON JULY 9, 1983 JOHN E. HOLLINGSWORTH 691

OREGON CORNER RESTORATION FORM

Section 29 Township 33S Range 2E

County Jackson Date May 8, 1984

Corner Designation

C-W-W 1/64

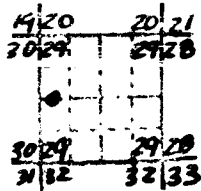

- Condition Report Only
- Not Found
- Renewed
- Unrecorded
- Surveyed In
- Referenced Out

Previous Renewals/Surveys, etc. _____

Monument(s) & Accessories Found: (Condition and Source)

Monument Detail

Sketch

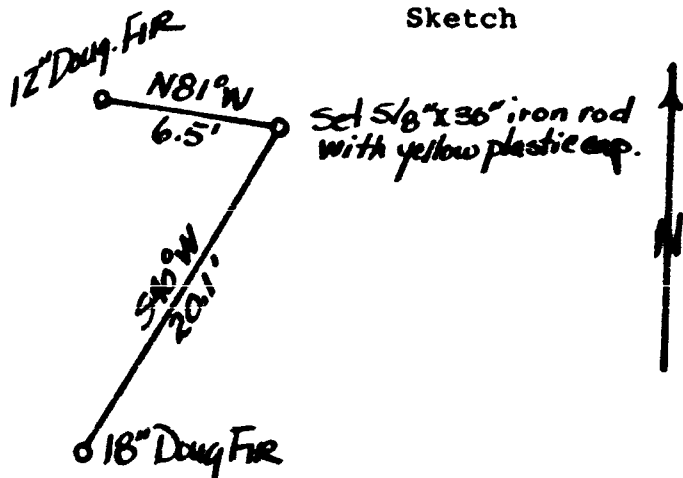

Monument Set (Procedures and Description)

Set 5/8"x30" iron rod with yellow plastic cap marked "OREGON STATE PARKS" in a mound of stones, 0.4' from a 43" diameter Douglas fir.

New Accessories

12" diameter Douglas fir N81°W, 6.5' scribed "CWW1/64 S29BT".
18" diameter Douglas fir S40°W, 20.1' scribed "CWW1/64 S29BTRS691" with park corner tag. Set fiberglass post with decal marked "PROPERTY BOUNDARY-STATE PARK LAND BEHIND THIS SIGN" 2.0' north.

Location & Comments

Stewart State Park
All bearings and distances by hand compass and steel tape.
Drawing not to scale.

Compass Declination 20 1/2° E
Firm/Agency Oregon State Parks & Recreation Div.
Address 525 Trade St. SE
Salem OR 93710
Party Chief Craig Holt
Notes Craig Holt
Witness G. Cottrell, B. Staggs

Surveyor's Seal

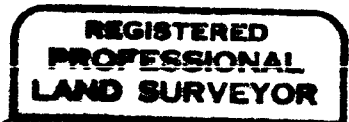

John E. Hollingsworth

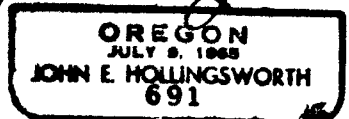

OREGON CORNER RESTORATION FORM

Section 30 Township 33S Range 2E

County Jackson Date June 6, 1984

Corner Designation

Quarter Corner

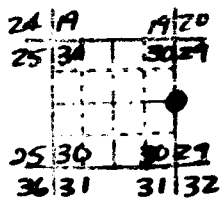

- Condition Report Only
- Not Found
- Renewed
- Unrecorded
- Surveyed In
- Referenced Out

Previous Renewals/Surveys, etc. _____

Jackson County Surveyor, 1969. Hoffbuhr, Bath & Associates, Inc., 1983

Monument(s) & Accessories Found: (Condition and Source)

Found 2 1/2" brass cap on a 1" iron pipe protruding 0.5' above ground with 1 1/2"x30" pipe and original stone set along side.

Found 36" diameter Douglas fir, N65°E, 35.6', visible scribing "BT".

Found 34" diameter Douglas fir, S01°E, 32.0', visible blaze.

Found 12" diameter Douglas fir bears N65°E, 0.7', visible blaze.

Monument Detail

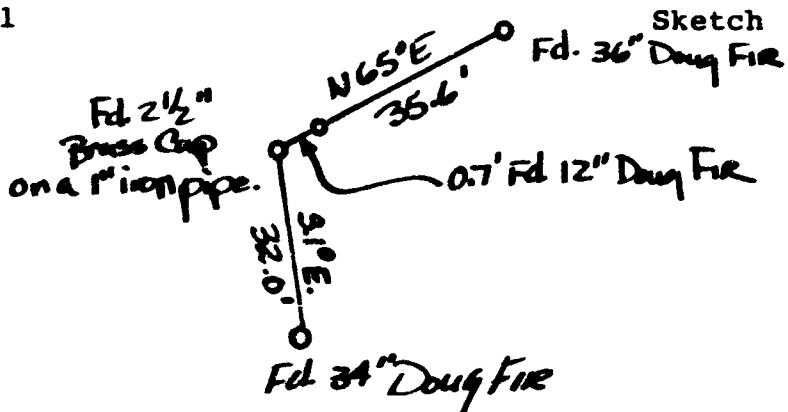

Monument Set (Procedures and Description)

New Accessories

Set fiberglass post with a decal marked "PROPERTY BOUNDARY-STATE PARK LAND BEHIND THIS SIGN" 2.0' north.

Location & Comments

Stewart State Park Compass Declination 20 1/2° E
All bearings and Firm/Agency Oregon State
distances by hand compass Parks & Recreation Div.
and steel tape. Address 525 Trade St. SE
Drawing not to scale. Salem OR 97310
 Party Chief Craig Holt
 Notes Craig Holt
 Witness G. Cottrell, B. Staggs

Surveyor's Seal



OREGON CORNER RESTORATION FORM

Section 30 Township 33S Range 2E

County Jackson Date June 6, 1984

Corner Designation

Center Quarter

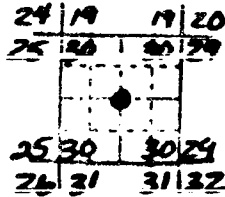

- Condition Report Only
- Not Found
- Renewed
- Unrecorded
- Surveyed In
- Referenced Out

Previous Renewals/Surveys, etc.

BLM 1973, Hoffbuhr, Bath & Associates, Inc., 1983

Monument(s) & Accessories Found: (Condition and Source)

Found 3" brass capped iron pipe in a mound of stones, protruding 0.4' out of the rock mound.

Found 13" diameter white fir, S85°W, 18.5' visible blaze.

Found 18" madrona, N52°W, 17.7', visible blaze.

Found 21" diameter Douglas fir, N6°E, 10.9', visible blaze.

Found 11" diameter white fir, N32°E, 28.0', visible blaze.

Found 28" diameter Douglas fir, S81°E, 9.5', visible blaze.

Monument Detail

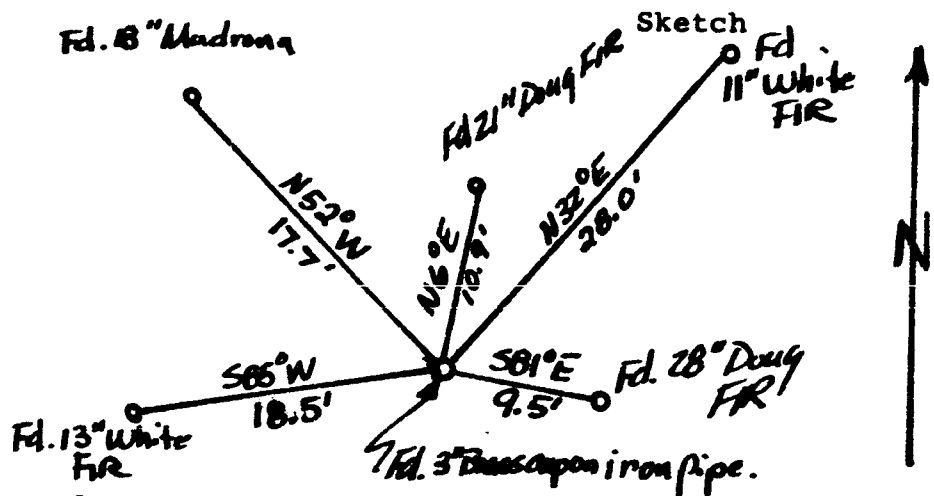
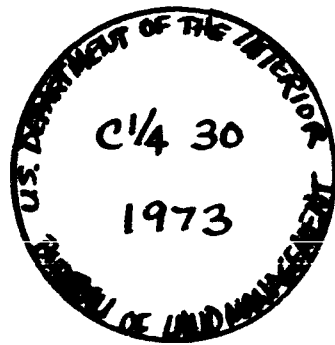

Monument Set (Procedures and Description)

New Accessories

Set fiberglass post with decal marked "PROPERTY BOUNDARY-STATE PARK LAND BEHIND THIS SIGN" 2.0' north.

Location & Comments

Stewart State Park Compass Declination 20.5°E

All bearings and distances Firm/Agency Oregon State

by hand compass and Parks & Recreation Div.

steel tape. Address 525 Trade St. SE

Drawing not to scale. Salem OR 97310

Party Chief Craig Holt

Notes Craig Holt

Witness G. Cottrell

Surveyor's Seal

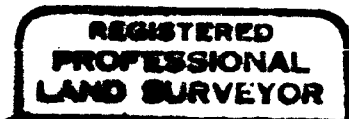

John E. Hollingsworth

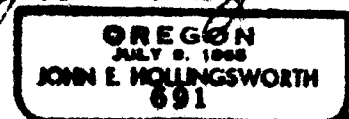

OREGON CORNER RESTORATION FORM

Section 30 Township 33S Range 2E

County Jackson Date June 13, 1984

Corner Designation

Quarter Corner

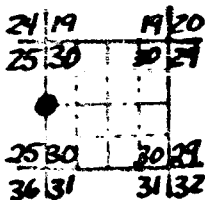

- Condition Report Only
- Not Found
- Renewed
- Unrecorded
- Surveyed In
- Referenced Out

Previous Renewals/Surveys, etc. Jackson County Surveyor 1969;
BLM 1973, Hoffbuhr/Bath & Associates, Inc., 1983

Monument(s) & Accessories Found: (Condition and Source)

- Found 3" brass cap on an iron pipe in a rock mound.
 - Found 8" diameter fir, S86°W, 23.5', visible blaze.
 - Found fallen decaying Madrona N14°E, 11.3', visible scribing.
 - Found 24" diameter oak, N37°E, 5.5', visible blaze.
 - Found 15" diameter fir, N61°E, 39.8', visible blaze.
- Note: All BT's have BLM yellow metal BT tags.

Monument Detail

Sketch

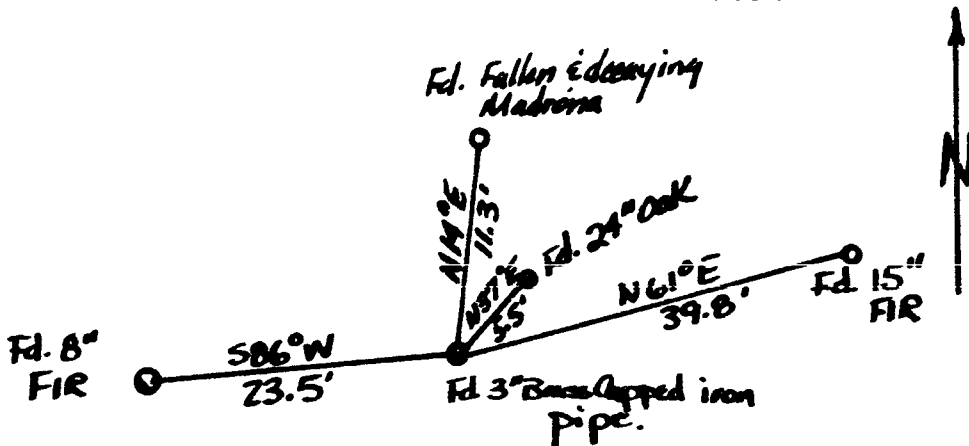
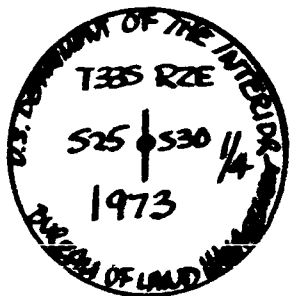

Monument Set (Procedures and Description)

New Accessories

Location & Comments

Stewart State Park

All bearings and

distances by hand compass

and steel tape.

Drawing not to scale.

Compass Declination 20 1/2° E

Firm/Agency Oregon State

Parks & Recreation Div.

Address 525 Trade St. SE

Salem OR 97310

Party Chief Craig Holt

Notes Craig Holt

Witness G. Cottrell, B. Staggs

Surveyor's Seal

REGISTERED
PROFESSIONAL
LAND SURVEYOR

John E. Hollingsworth

OREGON
JULY 9, 1969
JOHN E. HOLLINGSWORTH
691

OREGON CORNER RESTORATION FORM

Section 29 Township 33S Range 2E

County Jackson Date Nov. 8, 1984

Corner Designation

C-S-NW 1/4

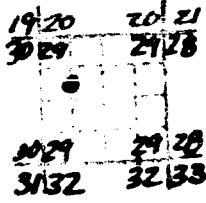

- Condition Report Only
- Not Found
- Renewed
- Unrecorded
- Surveyed In
- Referenced Out

Previous Renewals/Surveys, etc. _____

Monument(s) & Accessories Found: (Condition and Source)

Monument Detail

Sketch

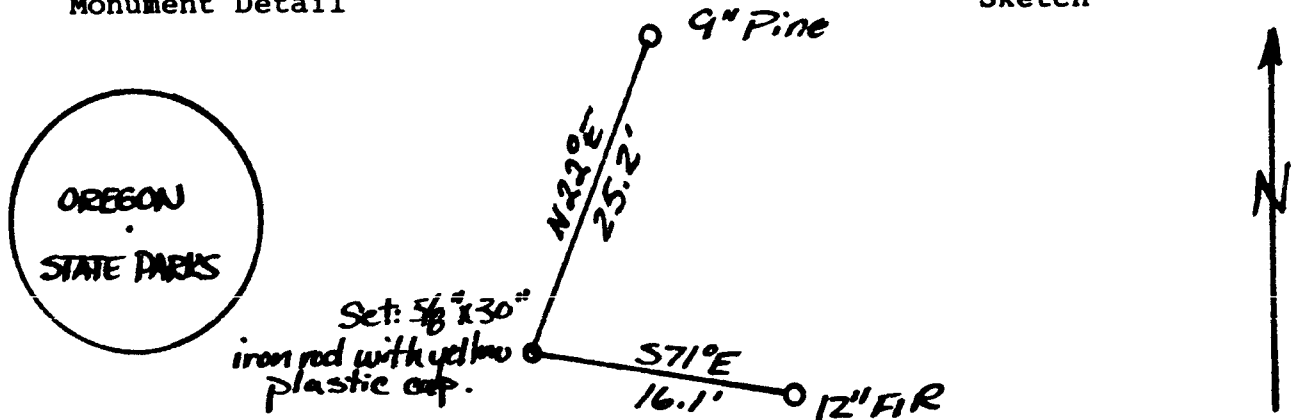

Monument Set (Procedures and Description)

Set 5/8"x30" iron rod with yellow plastic cap marked "OREGON STATE PARKS" in a small mound of stones.

New Accessories

12" diameter fir S71°E, 16.1' scribed "CSNW1/64 S29BT".

9" diameter pine N22°E, 25.2' scribed "CSNW1/64 S29BT".

Set fiberglass post with decal marked "PROPERTY BOUNDARY-STATE PARK LAND BEHIND THIS SIGN" 2.0' west.

Location & Comments

Surveyor's Seal

Stewart State Park _____ Compass Declination 20 1/2° E
 All bearings and _____ Firm/Agency Oregon State
 distances by hand compass _____ Parks & Recreation Div.
 and steel tape. _____ Address 525 Trade St. SE
 Drawing not to scale. _____ Salem OR 97310
 _____ Party Chief Craig Holt
 _____ Notes Craig Holt
 _____ Witness M. Bradetich

REGISTERED PROFESSIONAL LAND SURVEYOR

John E. Hollingsworth

OREGON JULY 9, 1968 JOHN E. HOLLINGSWORTH 691

21.

OREGON CORNER RESTORATION FORM

Section 29 Township 33S Range 2E

County Jackson Date Nov. 9, 1984

Corner Designation

N.W. 1/16

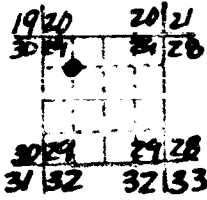

- Condition Report Only
- Not Found
- Renewed
- Unrecorded
- Surveyed In
- Referenced Out

Previous Renewals/Surveys, etc. _____

Monument(s) & Accessories Found: (Condition and Source)

Monument Detail

Sketch

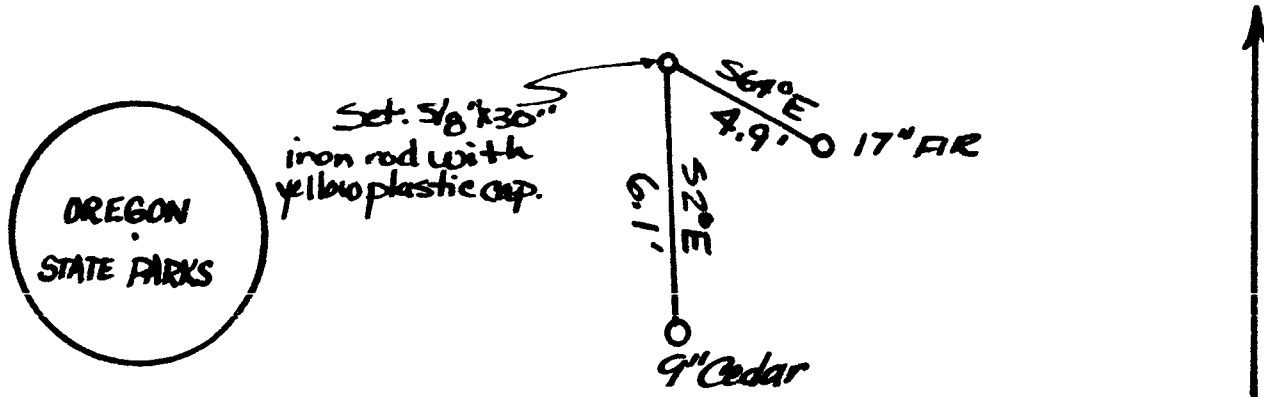

Monument Set (Procedures and Description)

Set 5/8"x30" iron rod with yellow plastic cap marked "OREGON STATE PARKS" in a mound of stones.

New Accessories

9" diameter cedar S20°E, 6.1' scribed "NW1/16 S29BT RS691".

17" diameter fir S64°E, 4.9' scribed "NW1/16 S29BT".

Set fiberglass post with decal marked "PROPERTY BOUNDARY-STATE PARK LAND BEHIND THIS SIGN" 2.0' west.

Location & Comments

Stewart State Park
 All bearings and distances by hand compass and steel tape.
 Drawing not to scale.

Compass Declination 20°E
 Firm/Agency Oregon State Parks & Recreation Div.
 Address 525 Trade St. SE Salem OR 93710
 Party Chief Craig Holt
 Notes Craig Holt
 Witness M. Bradetich

Surveyor's Seal

REGISTERED
 PROFESSIONAL
 LAND SURVEYOR

John E. Hollingsworth

OREGON
 JULY 9, 1963
 JOHN E. HOLLINGSWORTH
 691

20

OREGON CORNER RESTORATION FORM

Section 29 Township 33S Range 2E

County Jackson Date Nov. 19, 1984

Corner Designation

C-N-NW 1/64

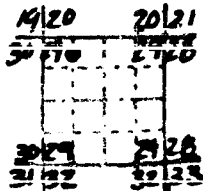

- Condition Report Only
- Not Found
- Renewed
- Unrecorded
- Surveyed In
- Referenced Out

Previous Renewals/Surveys, etc. _____

Monument(s) & Accessories Found: (Condition and Source)

Monument Detail

Sketch

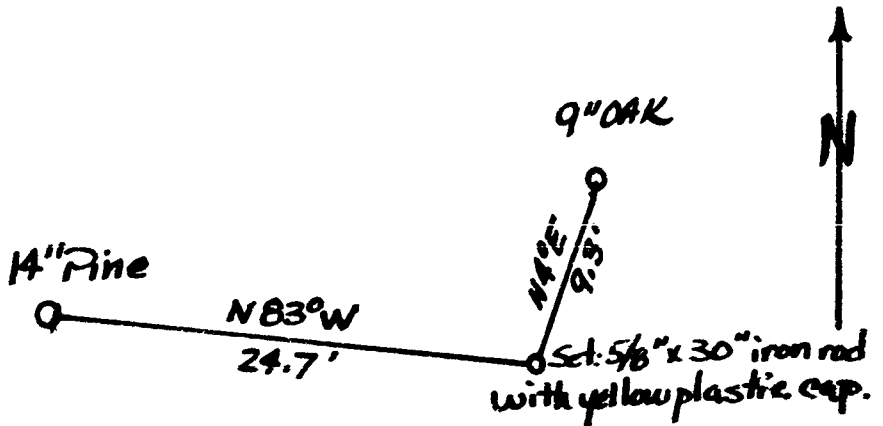

Monument Set (Procedures and Description)

Set 5/8"x30" iron rod with yellow plastic cap marked "OREGON STATE PARKS" in a small mound of stones.

New Accessories

14" diameter pine N83°W, 24.7' scribed "CNNW1/64 S29 BT".

9" diameter Oak N40°E, 9.3' scribed "CNNW1/64 S29 BT".

Set fiberglass post with decal marked "PROPERTY BOUNDARY-STATE PARK LAND BEHIND THIS SIGN" 2.0' west.

Location & Comments

Stewart State Park
All bearings by hand
compass and steel tape.
Drawing not to scale.

Compass Declination 20 1/2° E
Firm/Agency Oregon State Parks & Recreation Div.
Address 525 Trade St. SE
Salem OR 93710
Party Chief Craig Holt
Notes Craig Holt
Witness M. Bradetich

Surveyor's Seal

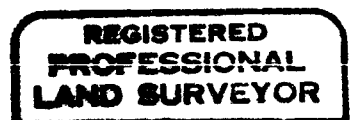

John E. Hollingsworth

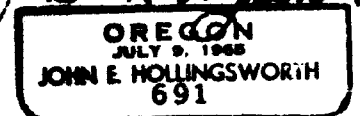

OREGON CORNER RESTORATION FORM

Section 20 Township 33S Range 2E

County Jackson Date June 6, 1984

Corner Designation

Section Corner

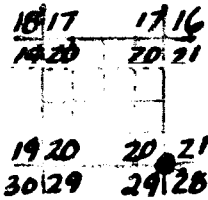

- Condition Report Only
- Not Found
- Renewed
- Unrecorded
- Surveyed In
- Referenced Out

Previous Renewals/Surveys, etc.

BLM 1965, Hoffbuhr/Bath & Associates, Inc., 1983

Monument(s) & Accessories Found: (Condition and Source)

Found 3" brass cap, BLM, on iron pipe protruding 0.5' out of ground.

Found 8" diameter white fir N66°E, 9.1' visible blaze.

Found 17" diameter white fir, S26°E, 7.3', visible blaze.

Found 10" diameter white fir S78°W, 49.5', visible blaze.

Found 19" diameter white fir, N80°W, 18.3', visible blaze.

Monument Detail

Sketch

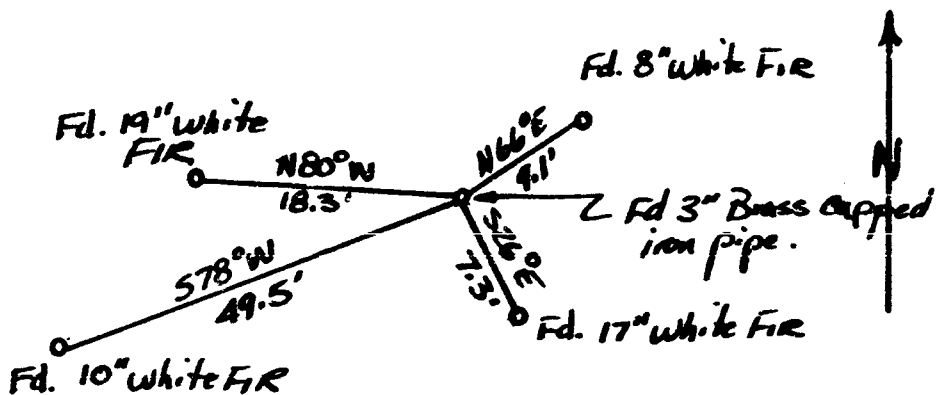
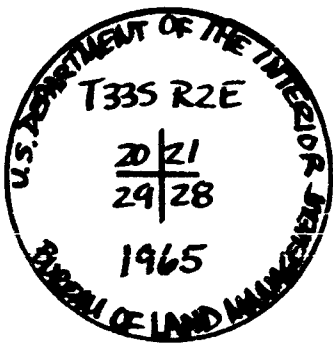

Monument Set (Procedures and Description)

New Accessories

Location & Comments

Stewart State Park
All bearings by hand
compass and steel tape.
Drawing not to scale.

Compass Declination 20 1/2° E
 Firm/Agency Oregon State
Parks & Recreation Div.

Address 525 Trade St. SE
Salem OR 97310

Party Chief Craig Holt
 Notes Craig Holt

Witness G. Cottrell, B. Staggs

Surveyor's Seal

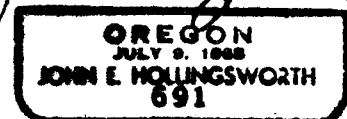
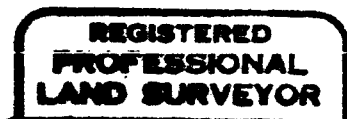

OREGON CORNER RESTORATION FORM

Section 20 Township 33S Range 2E

County Jackson Date March 16, 1984

Corner Designation

E.-E. 1/64

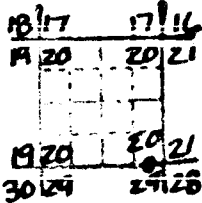

- Condition Report Only
- Not Found
- Renewed
- Unrecorded
- Surveyed In
- Referenced Out

Previous Renewals/Surveys, etc. _____

Monument(s) & Accessories Found: (Condition and Source)

Monument Detail

Sketch

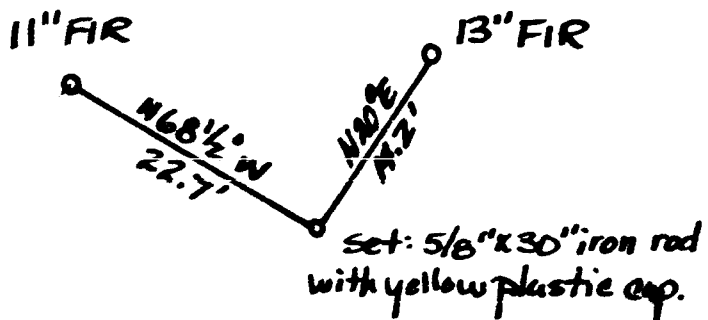

Monument Set (Procedures and Description)

Set 5/8"x30" iron rod with yellow plastic cap marked "OREGON STATE PARKS" in a mound of stones.

New Accessories

11" diameter fir N68⁰/₂W, 22.7', scribed "EE1/64 S20 BT RS691". 13" diameter fir N20⁰E, 14.2', scribed "EE1/64 S20 BT" with a parks corner tag. Set fiberglass post with decal marked "PROPERTY BOUNDARY-STATE PARK LAND BEHIND THIS SIGN" 2.0' north.

Location & Comments

Stewart State Park Compass Declination 20⁰/₂E
 All bearings and distances Firm/Agency Oregon State
by hand compass and Parks & Recreation Div.
steel tape. Address 525 Trade St. SE
Drawing not to scale. Salem OR 97310
Party Chief Craig Holt
Notes Craig Holt
Witness G. Cottrell, B. Staggs

Surveyor's Seal



OREGON CORNER RESTORATION FORM

Section 20 Township 33S Range 2E

County Jackson Date March 16, 1984

Corner Designation

E. 1/16

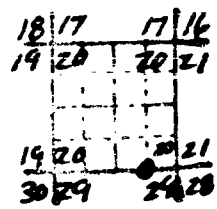

- Condition Report Only
- Not Found
- Renewed
- Unrecorded
- Surveyed In
- Referenced Out

Previous Renewals/Surveys, etc. _____

Monument(s) & Accessories Found: (Condition and Source)

Monument Detail

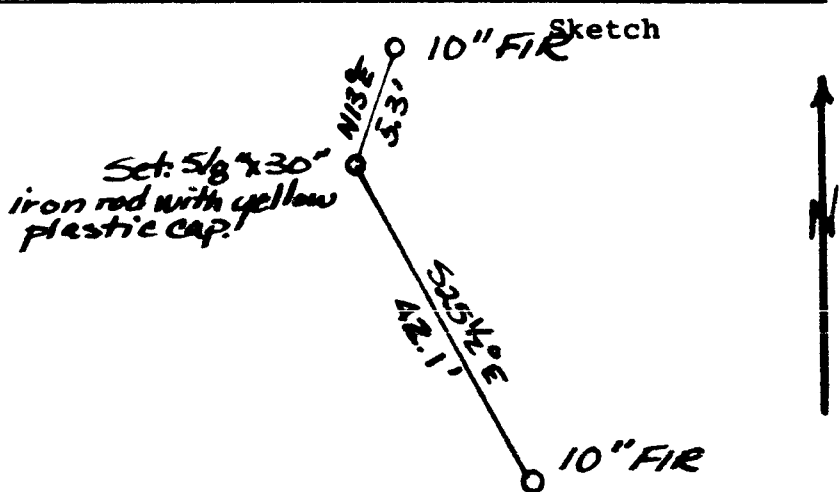

Monument Set (Procedures and Description)

Set 5/8"x30" iron rod with yellow plastic cap marked "OREGON STATE PARKS" in a mound of stones.

New Accessories

10" diameter fir S25⁰ E, 42.1' scribed "E1/16 S29 BT". 10" diameter fir N13⁰ E, 5.3' scribed "E1/16 S20 BT RS691" with Parks corner tag. Set fiberglass post with decal marked "PROPERTY BOUNDARY-STATE PARK LAND BEHIND THIS SIGN" 2.0' north.

Location & Comments

Stewart State Park
All bearings and distances by hand compass and steel tape.
Drawing not to scale.

Compass Declination 20⁰ E
Firm/Agency Oregon State Parks & Recreation Div.
Address 525 Trade St. SE
Salem OR 97310
Party Chief Craig Holt
Notes Craig Holt
Witness G. Cottrell, B. Staggs

Surveyor's Seal

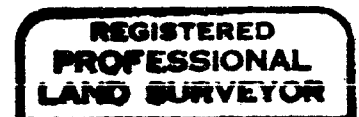

John E. Hollingsworth



OREGON CORNER RESTORATION FORM

Section 20 Township 33S Range 2E

County Jackson Date March 15, 1984

Corner Designation

W.-E. 1/64

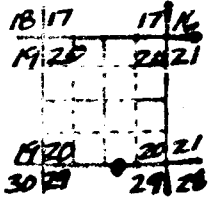

- Condition Report Only
- Not Found
- Renewed
- Unrecorded
- Surveyed In
- Referenced Out

Previous Renewals/Surveys, etc. _____

Monument(s) & Accessories Found: (Condition and Source)

Monument Detail

Sketch

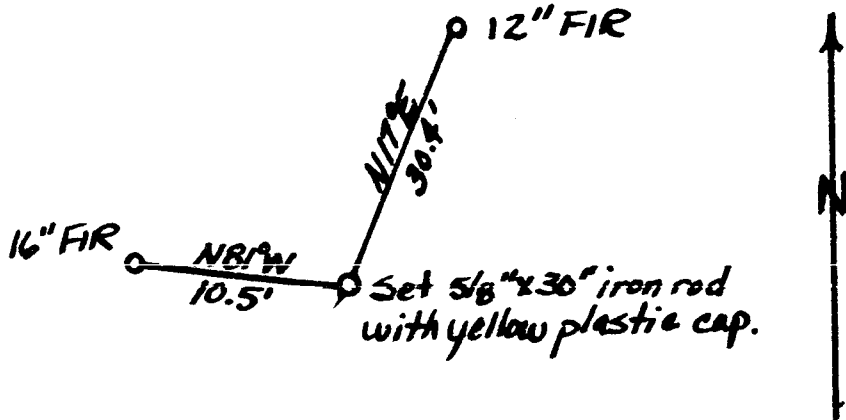

Monument Set (Procedures and Description)

Set 5/8" x 30" iron rod with yellow plastic cap marked "OREGON STATE PARKS" in a small mound of stones.

New Accessories

16" diameter fir N81°W, 10.5', scribed "T33S R2E WE1/64 S20 BT" with Parks corner tag. 12" diameter fir N17°E, 30.4', scribed "WE1/64 S20 RS691 BT". Set fiberglass post with decal marked "PROPERTY BOUNDARY-STATE PARK LAND BEHIND THIS SIGN" 2.0' north.

Location & Comments

Stewart State Park
All bearings and distances by hand compass and steel tape. Drawing not to scale.

Compass Declination 20 1/2° E
Firm/Agency Oregon State Parks & Recreation Div.
Address 525 Trade St. SE Salem OR 97310
Party Chief Craig Holt
Notes Craig Holt
Witness G. Cottrell, B. Staggs

Surveyor's Seal

REGISTERED PROFESSIONAL LAND SURVEYOR

John E. Hollingsworth

OREGON
JULY 9, 1983
JOHN E. HOLLINGSWORTH
691

OREGON CORNER RESTORATION FORM

Section 20 Township 33S Range 2E

County Jackson Date March 14, 1984

Corner Designation

Quarter Corner

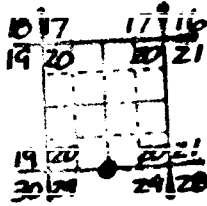

- Condition Report Only
- Not Found
- Renewed
- Unrecorded
- Surveyed In
- Referenced Out

Previous Renewals/Surveys, etc. _____

Jackson County Surveyor, 1969, Hoffbuhr/Bath & Associates, Inc., 1983.

Monument(s) & Accessories Found: (Condition and Source)

Found 2 1/2" brass cap on a 1"x36" galvanized iron pipe. Original 1"x7"x12" shale stone marked "1/4" found along side. 24" diameter white fir snag scribed "1/4S", N28°W, 36.1'. 28" diameter white fir healed blaze, S82°W, 23.0'. 15" diameter white fir scribed "CS-BT" N12°E, 56.6'. 14" diameter white fir scribed "CS-BT", S40°E, 22.3'.

Monument Detail

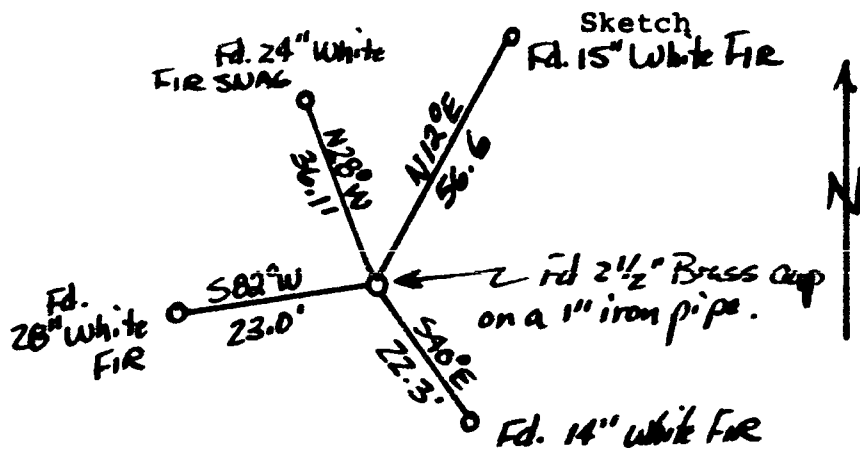
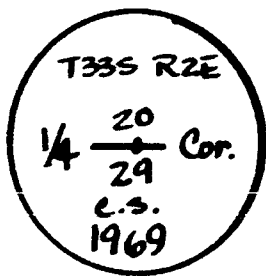

Monument Set (Procedures and Description)

New Accessories

Set: fiberglass post with decal marked "PROPERTY BOUNDARY-STATE PARK LAND BEHIND THIS SIGN" 2.0' north.

Location & Comments

Stewart State Park Compass Declination 20 1/2° E
All bearings and distances by hand compass and steel tape. Drawing not to scale. Firm/Agency Oregon State Parks & Recreation Div.
 Address 525 Trade St. SE Salem OR 97310
 Party Chief Craig Holt
 Notes Craig Holt
 Witness G. Cottrell, B. Staggs

Surveyor's Seal

REGISTERED
 PROFESSIONAL
 LAND SURVEYOR

John E. Hollingsworth

OREGON
 JULY 9, 1983
 JOHN E. HOLLINGSWORTH
 691

14.

OREGON CORNER RESTORATION FORM

Section 20 Township 33S Range 2E

County Jackson Date March 14, 1984

Corner Designation

E-W 1/64

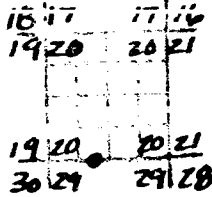

- Condition Report Only
- Not Found
- Renewed
- Unrecorded
- Surveyed In
- Referenced Out

Previous Renewals/Surveys, etc. _____

Monument(s) & Accessories Found: (Condition and Source)

Monument Detail



Set: 5/8" x 30" iron rod with yellow plastic cap

Sketch
1 1/2" FIR

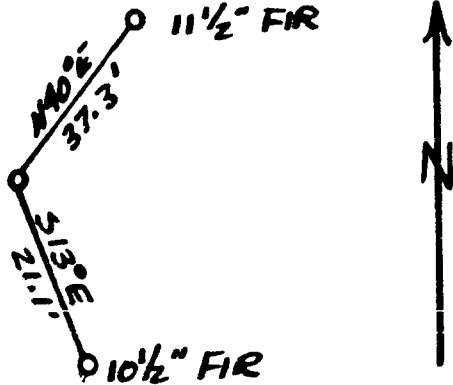

Monument Set (Procedures and Description)

Set 5/8"x30" iron rod with yellow plastic cap marked "OREGON STATE PARKS" in a small mound of stones.

New Accessories

11' diameter fir, N40°E, 37.3', scribed "EW1/64S20RS691BT", with Parks corner tag. 10" diameter fir, S13°E, 21.1', scribed "T33SR2E EW1/64 S20 BT". Set fiberglass post with decal marked "PROPERTY BOUNDARY-STATE PARK LAND BEHIND THIS SIGN" 1.7' north.

Location & Comments

Stewart State Park
All bearings and distances by hand compass and steel tape. Drawing not to scale.

Compass Declination 20°E
Firm/Agency Oregon State Parks & Recreation Div.
Address 525 Trade St. SE Salem OR 97310
Party Chief Craig Holt
Notes Craig Holt
Witness G. Cottrell, B. Staggs

Surveyor's Seal

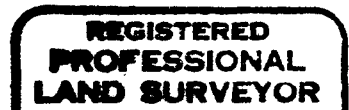

John E. Hollingsworth



OREGON CORNER RESTORATION FORM

Section 20 Township 33S Range 2E

County Jackson Date March 14, 1984

Corner Designation

W. 1/16

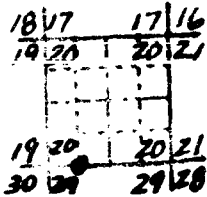

- Condition Report Only
- NOT FOUND
- Renewed
- Unrecorded
- Surveyed In
- Referenced Out

Previous Renewals/Surveys, etc. _____

Monument(s) & Accessories Found: (Condition and Source)

Monument Detail

Sketch

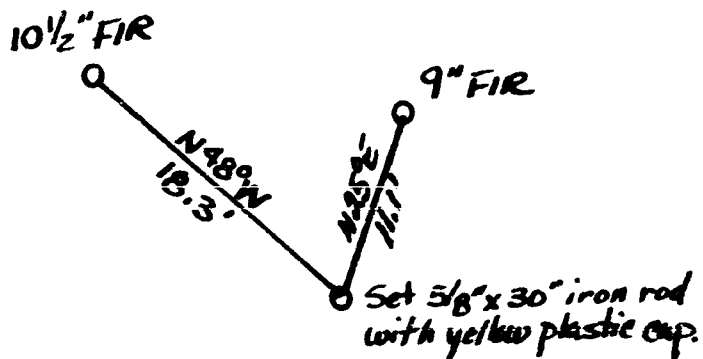
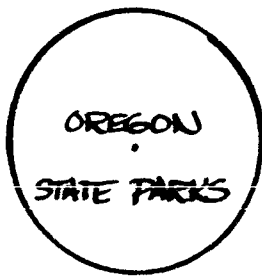

Monument Set (Procedures and Description)

Set 5/8"x30" iron rod with yellow plastic cap marked "OREGON STATE PARKS" in a mound of stones.

New Accessories

10" diameter fir N48°W, 18.3', scribed "T33SR2ES20W1/16BT" with Parks corner tag.
2" diameter fir N25°E, 11.1' scribed "S20 W 1/16 RS691BT".
Set fiberglass post with decal marked "PROPERTY BOUNDARY-STATE PARK LAND BEHIND THIS SIGN" 3.0' northwest.

Location & Comments

Stewart State Park. Compass Declination 20 1/2° E
All bearings and distances by hand compass and steel tape. Firm/Agency Oregon State Parks & Recreation Div.
Drawing not to scale. Address 525 Trade St. SE Salem OR 97310
Party Chief Craig Holt
Notes Craig Holt
Witness G. Cottrell, B. Staggs

Surveyor's Seal

REGISTERED PROFESSIONAL LAND SURVEYOR

John E. Hollingsworth

OREGON
JULY 9, 1905
JOHN E. HOLLINGSWORTH
691

OREGON CORNER RESTORATION FORM

Section 20 Township 33S Range 2E

County Jackson Date June 13, 1984

Corner Designation

Section Corner

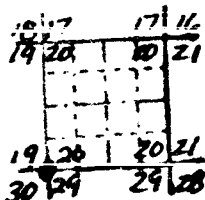

- Condition Report Only
- Not Found
- Renewed
- Unrecorded
- Surveyed In
- Referenced Out

Previous Renewals/Surveys, etc.

Jackson County surveyor, 1969, Hoffbuhr/Bath & Associates, Inc., 1983.
GLO - 1933

Monument(s) & Accessories Found: (Condition and Source)

Found 2 1/2" brass capped iron pipe protruding 1.6' out of a rock mound.

Found 58" diameter fir, S54°W, 77.0', visible blaze. Found 13" diameter

alder, S58°W, 58.1', visible blaze. Found 59" diameter fir, N62°E, 28.3',

visible bark scribe "T33SR2ES20BT". Found 39" diameter cedar, S74E, 23.9',

visible blaze.

NOTE: All BT's with yellow metal BLM BT tags.

Monument Detail

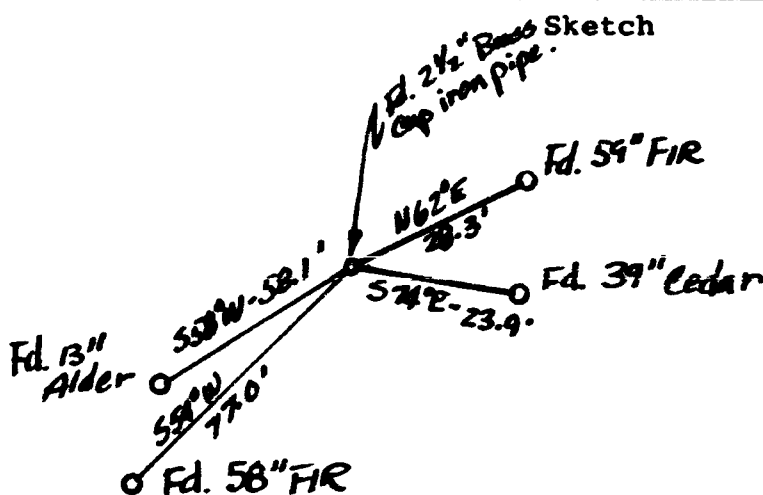
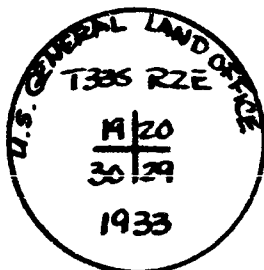

Monument Set (Procedures and Description)

New Accessories

Location & Comments

Stewart State Park Compass Declination 20.0° E
All bearings and Firm/Agency Oregon State
distances by hand compass Parks & Recreation Div.
and steel tape. Address 525 Trade St. SE
Salem OR 97310
 Party Chief Craig Holt
 Notes Craig Holt
 Witness G. Cottrell, B. Staggs

Surveyor's Seal

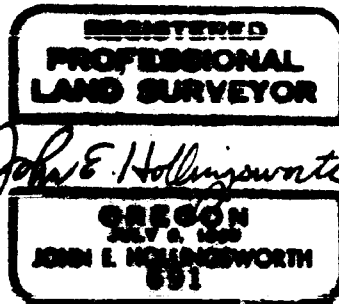

OREGON CORNER RESTORATION FORM

Section 20 Township 33S Range 2E

County Jackson Date May 17, 1984

Corner Designation

S-S. 1/64



- Condition Report Only
- Not Found
- Renewed
- Unrecorded
- Surveyed In
- Referenced Out

Previous Renewals/Surveys, etc. _____

Monument(s) & Accessories Found: (Condition and Source)

Monument Detail

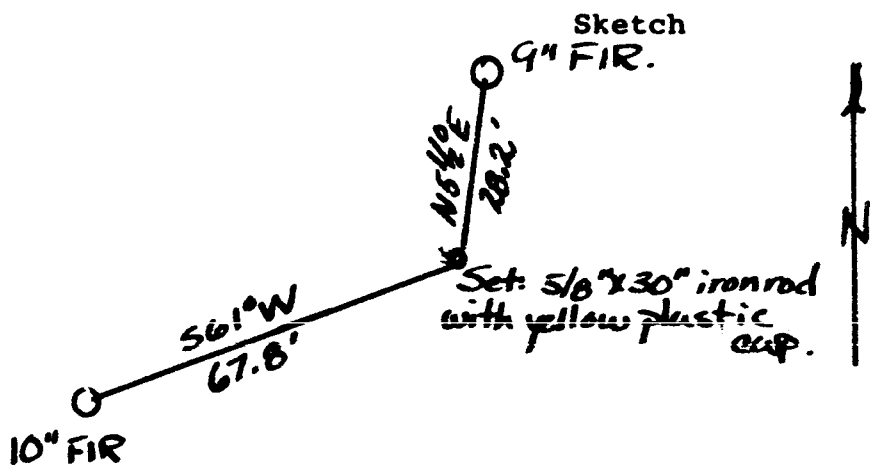

Monument Set (Procedures and Description)

Set 5/8"x30" iron rod with yellow plastic marked "OREGON STATE PARKS".

New Accessories

10" diameter fir S61W, 67.8', scribed "SS 1/64S20BT". 9" diameter fir

N5 1/2° E, 28.2', scribed "SS1/64S20BTRS691" with Parks corner tag.

Set fiberglass post with decal marked "PROPERTY BOUNDARY-STATE PARKS LAND BEHIND THIS SIGN" 2.0' east.

Location & Comments

Stewart State Park Compass Declination 20 1/2° E

All bearings and distances Firm/Agency Oregon State

by hand compass and steel Parks & Recreation Div.

tape, Address 525 Trade St. SE

Salem OR 93710

Party Chief Craig Holt

Notes Craig Holt

Witness G. Cottrell, D. Polly, B. Staggs

Surveyor's Seal

REGISTERED
PROFESSIONAL
LAND SURVEYOR

John E. Hollingsworth

OREGON
JULY 9, 1988
JOHN E. HOLLINGSWORTH
691

10.

OREGON CORNER RESTORATION FORM

Section 20 Township 33S Range 2E

County Jackson Date May 17, 1984

Corner Designation

S. 1/16

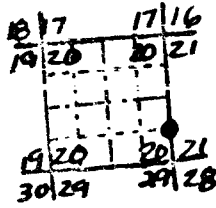

- Condition Report Only
- Not Found
- Renewed
- Unrecorded
- Surveyed In
- Referenced Out

Previous Renewals/Surveys, etc.

Monument(s) & Accessories Found: (Condition and Source)

Found 1 1/2" alum capped rebar marked "MEDCO 673" grid N26° 09'15"W, 12.19'.
No B.T.'s found.

Monument Detail

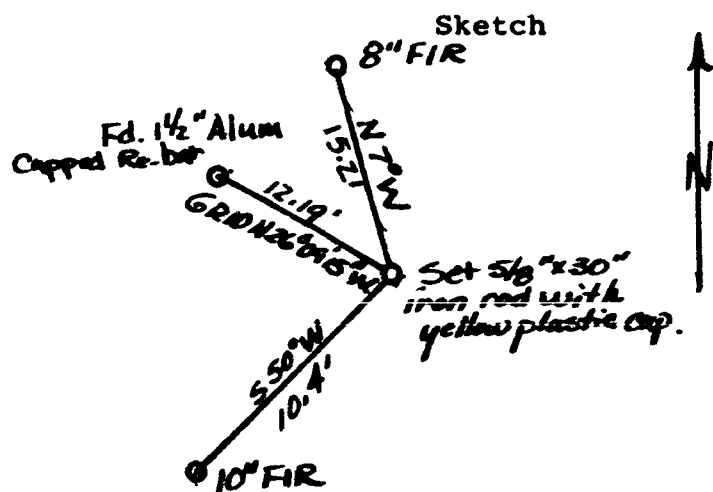

Monument Set (Procedures and Description)

Set 5/8"x30" iron rod with yellow plastic cap marked "OREGON STATE PARKS" in a mound of stones.

New Accessories

8" diameter fir N7°W, 15.2', scribed "S1/16S20BTRS691" with Parks corner tag. 10" diameter fir S50°W, 10.4', scribed "S1/16S20BT". Set fiberglass post with decal marked "PROPERTY BOUNDARY-STATE PARK LAND BEHIND THIS SIGN" 2.0' southwest.

Location & Comments

Stewart State Park
B.T. bearings and distances by hand compass and steel tape. Drawing not to scale. Theta angle of 1°26'30" to convert to true.
Compass Declination 20 1/2° E
Firm/Agency Oregon State Parks & Recreation Div.
Address 525 Trade St. SE Salem OR 97310
Party Chief Craig Holt
Notes Craig Holt
Witness G. Cottrell, B. Staggs, D. Polly

Surveyor's Seal

REGISTERED PROFESSIONAL LAND SURVEYOR

John E. Hollingsworth

OREGON
JULY 9, 1988
JOHN E. HOLLINGSWORTH
691

OREGON CORNER RESTORATION FORM

Section 20 Township 33S Range 2E

County Jackson Date May 17, 1984

Corner Designation

C-E-SE 1/64

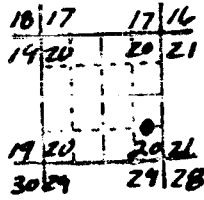

- Condition Report Only
- Not Found
- Renewed
- Unrecorded
- Surveyed In
- Referenced Out

Previous Renewals/Surveys, etc. _____

Monument(s) & Accessories Found: (Condition and Source)

Monument Detail

Sketch

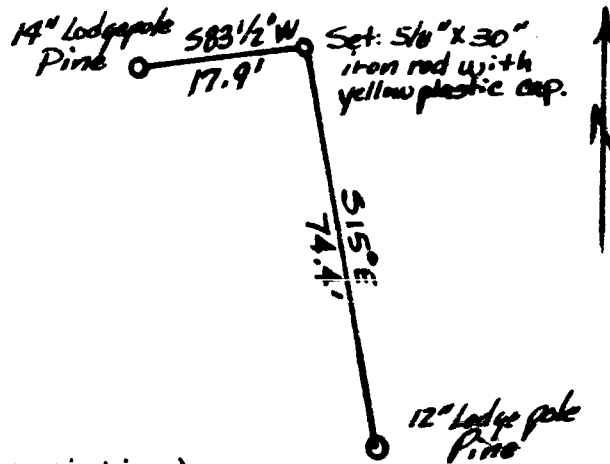
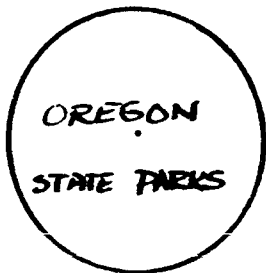

Monument Set (Procedures and Description)

Set 5/8"x30" iron rod with yellow plastic cap marked "OREGON STATE PARKS" in a large mound of stones.

New Accessories

14" diameter lodgepole pine S83 1/2 W, 17.9', scribed "CESE1/64S20BTRS691" with Parks corner tag. 12" diameter lodgepole pine S15 E, 74.4', scribed "CESE1/64S20BT". Set fiberglass post with decal marked "PROPERTY BOUNDARY-STATE PARK LAND BEHIND THIS SIGN" 2.0' south.

Location & Comments

Stewart State Park Compass Declination 20 1/2 E
All bearings and distances by hand compass and steel tape. Firm/Agency Oregon State Parks & Recreation Div.
Drawing not to scale. Address 525 Trade St. SE Salem OR 93710
 Party Chief Craig Holt
 Notes Craig Holt
 Witness G. Cottrell, B. Staggs

Surveyor's Seal

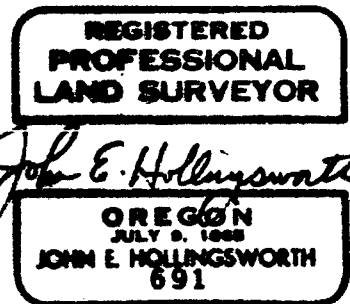

OREGON CORNER RESTORATION FORM

Section 20 Township 33S Range 2E

County Jackson Date May 17, 1984

Corner Designation

S.E. 1/16

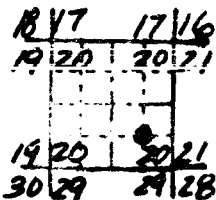

- Condition Report Only
- Not Found
 - Renewed
 - Unrecorded
 - Surveyed In
 - Referenced Out

Previous Renewals/Surveys, etc. _____

Monument(s) & Accessories Found: (Condition and Source)

Monument Detail

Sketch

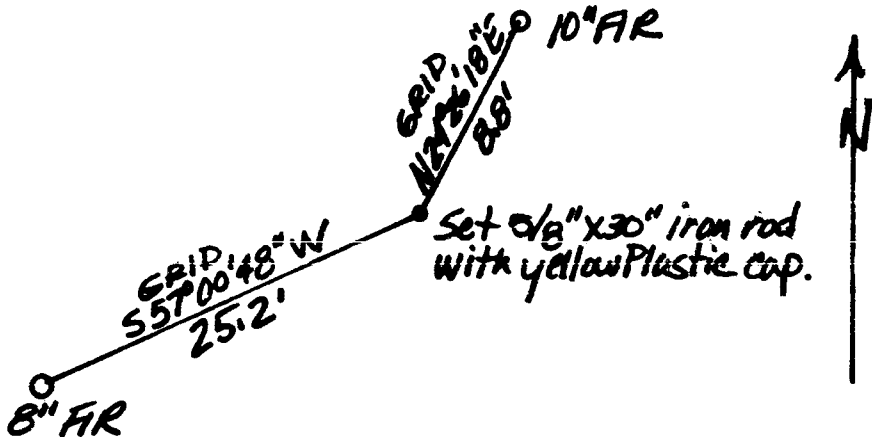

Monument Set (Procedures and Description)

Set 5/8"x30" iron rod with yellow plastic cap marked "OREGON STATE PARKS" in a small rock mound.

New Accessories

8" diameter fir grid S57⁰00'48"W, 25.2' scribed "SE1/16 S20BT". 10" diameter fir grid N24⁰26'18"E, 8.8' scribed "SE1/16 S20BT RS691" with Parks corner tag. Set fiberglass post with decal marked "PROPERTY BOUNDARY - STATE PARK LAND BEHIND THIS SIGN" 2.0' southwest.

Location & Comments

Surveyor's Seal

Stewart State Park
 Drawing not to scale.
 Bearings and distances by transit and steel tape. Theta angle of 1^o26'30" to convert to true.
 Compass Declination _____
 Firm/Agency Oregon State Parks & Recreation Div.
 Address 525 Trade St. SE Salem OR 97310
 Party Chief Craig Holt
 Notes Craig Holt
 Witness G. Cottrell, B. Staggs

REGISTERED PROFESSIONAL LAND SURVEYOR

John E. Hollingsworth

OREGON JULY 9, 1983 JOHN E. HOLLINGSWORTH 691

OREGON CORNER RESTORATION FORM

Section 20 Township 33S Range 2E

County Jackson Date May 17, 1984

Corner Designation

C-N-SE 1/64

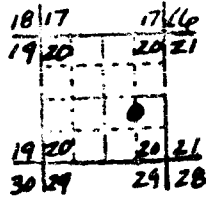

- Condition Report Only
- Not Found
- Renewed
- Unrecorded
- Surveyed In
- Referenced Out

Previous Renewals/Surveys, etc. _____

Monument(s) & Accessories Found: (Condition and Source)

Monument Detail

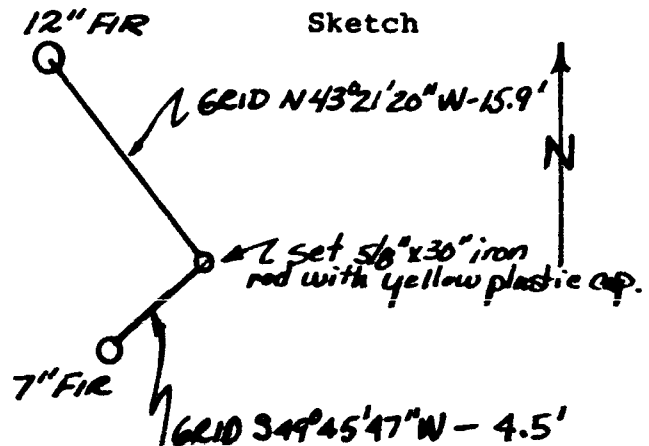

Monument Set (Procedures and Description)

Set 5/8"x30" iron rod with yellow plastic cap marked "OREGON STATE PARKS" in a mound of stones.

New Accessories

7" diameter fir, grid S49° 45'47"W, 4.5', scribed "CNSE1/64 S20BT RS691".
12" diameter fir grid N43° 21'20"W, 15.9', scribed "CNSE1/64S20BT". Set
Fiberglass post with decal marked "PROPERTY BOUNDARY - STATE PARK LAND
BEHIND THIS SIGN" 2.0' south.

Location & Comments

Stewart State Park
 Drawing not to scale.
 Bearings and distances by
 transit and steel tape.
 Theta angle of 1° 26' 30"
 to convert to true.

Compass Declination _____
 Firm/Agency Oregon State
 Parks & Recreation Div.
 Address 525 Trade St. SE
 Salem OR 97310
 Party Chief Craig Holt
 Notes Craig Holt
 Witness G. Cotrell, B. Staggs

Surveyor's Seal

REGISTERED
 PROFESSIONAL
 LAND SURVEYOR

John E. Hollingsworth

OREGON
 JULY 9, 1983
 JOHN E. HOLLINGSWORTH
 691

6.

OREGON CORNER RESTORATION FORM

Section 20 Township 33S Range 2E

County Jackson Date June 5, 1984

Corner Designation

Quarter Corner

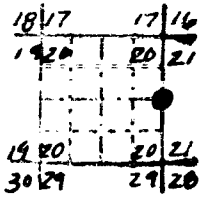

- Condition Report Only
- Not Found
- Renewed
- Unrecorded
- Surveyed In
- Referenced Out

Previous Renewals/Surveys, etc.

Jackson County Surveyor 1982, Hoffbuhr/Bath and Associates, Inc. 1983

Monument(s) & Accessories Found: (Condition and Source)

Found 2 1/2" brass cap on iron pipe in a mound of stones, protruding 0.8' above ground. Found rotted stump S56°E, 22.4', no visible blaze. Found 16" diameter fir S28°E, 11.1', visible blaze with County Surveyor's B.T. tag.

Found 6" diameter fir stump N71°W, 17.0', no visible blaze with County Surveyor's B.T. tag. Found rotted stump bears N38°W, 20.4', visible scribing.

Monument Detail

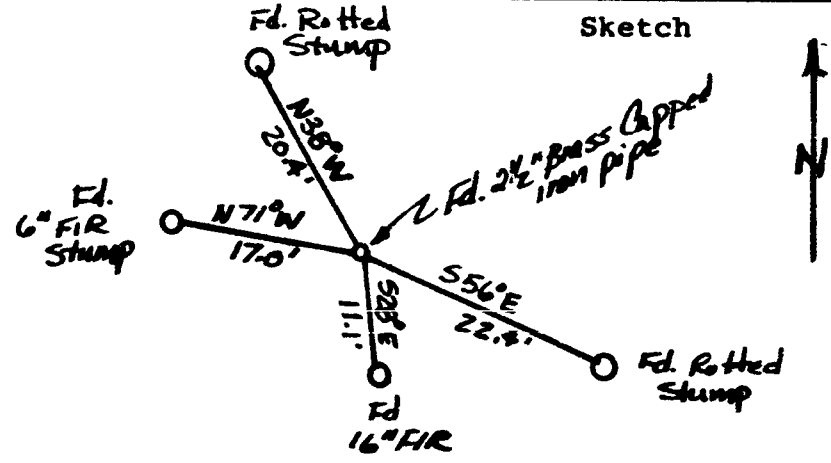
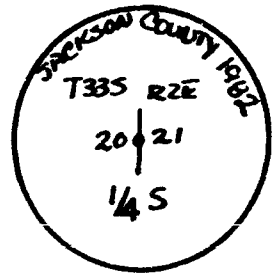

Monument Set (Procedures and Description)

New Accessories

Location & Comments

Stewart State Park Compass Declination 20 1/2° E

All bearings and distances by hand compass and steel tape. Drawing not to scale. Firm/Agency Oregon State Parks Division

Address 525 Trade St. SE Salem OR 97310

Party Chief Craig Holt

Notes Craig Holt

Witness G. Cottrell, B. Staggs

Surveyor's Seal

**REGISTERED
 PROFESSIONAL
 LAND SURVEYOR**

John E. Hollingsworth

**OREGON
 JULY 9, 1968
 JOHN E. HOLLINGSWORTH
 691**

5.

OREGON CORNER RESTORATION FORM

Section 20 Township 33S Range 2E

County Jackson Date May 17, 1984

Corner Designation

C-E 1/16

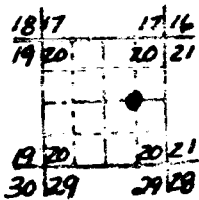

- Condition Report Only
- Not Found
- Renewed
- Unrecorded
- Surveyed In
- Referenced Out

Previous Renewals/Surveys, etc.

Hoffbuhr/Bath and Associates, Inc., 1983 Survey for USACE

Monument(s) & Accessories Found: (Condition and Source)

Found U.S. Corps of Engineer's 4" brass capped iron pipe marked as shown, 4" brass cap set in concrete grid N55° 39'38"W 28.69', stamping removed.

Monument Detail

Sketch

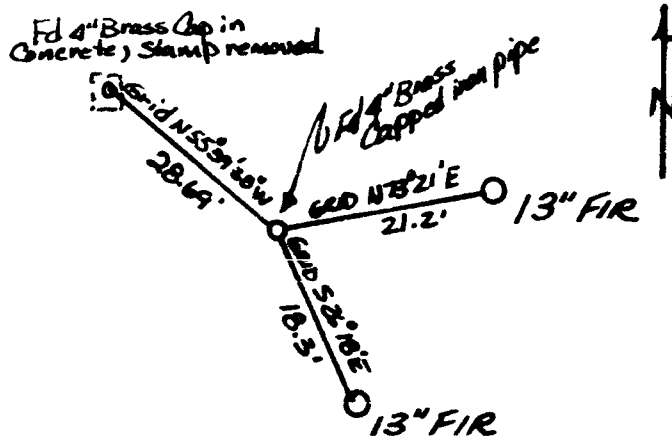
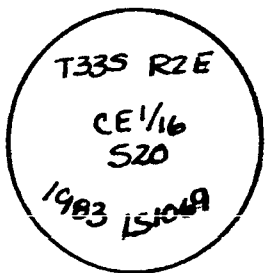

Monument Set (Procedures and Description)

New Accessories

13" diameter fir grid N73°21'E, 21.2', scribed "CE1/16S20BT" with Parks corner tag. 13" diameter fir grid S26°18'E, 18.3' scribed "CE1/16S20BT". Set fiberglass post with decal marked "Property Boundary-State Park Land Behind this Sign" 2.0' west.

Location & Comments

Stewart State Park
Drawing not to scale.
Bearings and distance by transit & steel tape.
Theta angle of 1°26'30" to convert to true bearing.

Compass Declination _____
Firm/Agency Oregon State Parks Division
Address 525 Trade St. SE Salem OR 97310
Party Chief Craig Holt
Notes Craig Holt
Witness G. Cottrell, B. Staggs

Surveyor's Seal

REGISTERED PROFESSIONAL LAND SURVEYOR

John E. Hollingsworth

OREGON JULY 9, 1983 JOHN E. HOLLINGSWORTH 691

OREGON CORNER RESTORATION FORM

Section 20 Township 33S Range 2E

County Jackson Date Oct. 28, 1983

Corner Designation

Quarter Corner

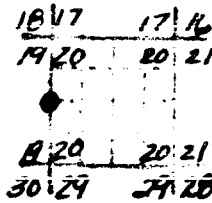

- Condition Report Only
- Not Found
- Renewed
- Unrecorded
- Surveyed In
- Referenced Out

Previous Renewals/Surveys, etc.

Jackson County Surveyor File 77-9, Hoffbuhr /Bath & Associates, Inc. 1983.

Monument(s) & Accessories Found: (Condition and Source)

Found 4" diameter USCE brass cap found in concrete, buried 0.8' below ground.

Found 21" diameter douglas fir stump with healed blaze, N15°W, 159.0'.

Found 8" diameter black oak, scribed "CS BT", N50°W, 146.6'. Found 2" metal BLM disk in center of decaying 39" diameter fir stump, N63°W, 152.6'.

Found Tack in lead plug, in concrete directly below water fountain at north side of Stewart State Park "D" restroom, S4°W, 176.24'.

Found 4" diameter USCE brass cap found in concrete, buried 0.8' below ground.

Monument Detail

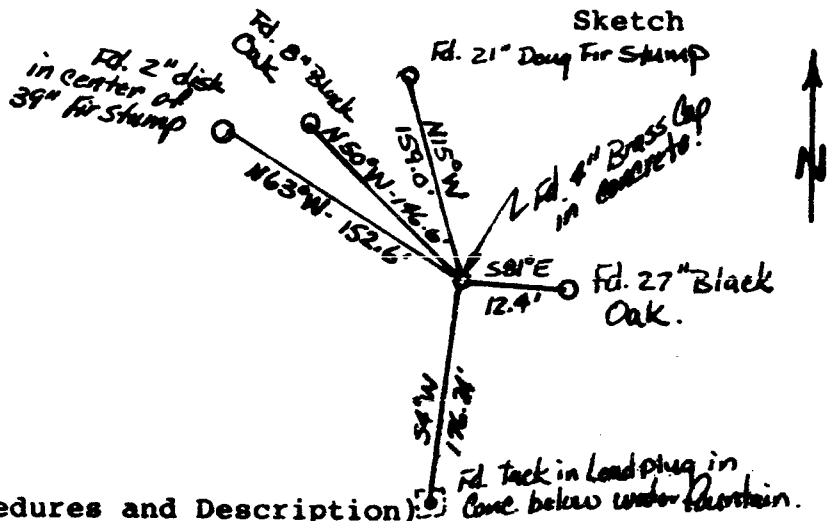
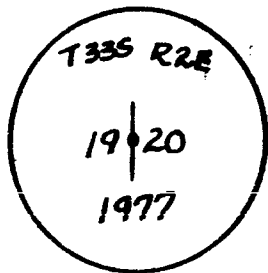

Monument Set (Procedures and Description):

New Accessories

Location & Comments

All bearings and distances by hand compass and steel tape. Located in "D" loop space #12. Drawing not to scale. Stewart State Park

Compass Declination 20 1/2° E
 Firm/Agency Oregon State Parks and Recreation Division
 Address 525 Trade St. SE Salem OR 97310
 Party Chief Craig Holt
 Notes Craig Holt
 Witness G. Cottrell, B. Staggs

Surveyor's Seal

REGISTERED
 PROFESSIONAL
 LAND SURVEYOR

John E. Hollingsworth

OREGON
 JULY 9, 1965
 JOHN E. HOLLINGSWORTH
 691

OREGON CORNER RESTORATION FORM

Section 20 Township 33S Range 2E

County Jackson Date June 6, 1984

Corner Designation

Section Corner

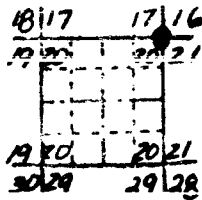

- Condition Report Only
- Not Found
- Renewed
- Unrecorded
- Surveyed In
- Referenced Out

Previous Renewals/Surveys, etc.

BLM 1973, Hoffhuhr Bath & Associates, Inc., 1983

Monument(s) & Accessories Found: (Condition and Source)

Found 2 1/2" brass cap on iron pipe in a mound of stones protruding 0.6' out of ground. Found 38" diameter fir N72°E, 54.0', visible blaze. Found 25" diameter fir S10°E, 6.6' visible blaze. Found 21" diameter fir S68°W, 25.4', visible scribes. Found 8" diameter fir, N27°W, 14.1', visible blaze.

Note: All B.T.'s have yellow metal BLM B.T. tags.

Monument Detail

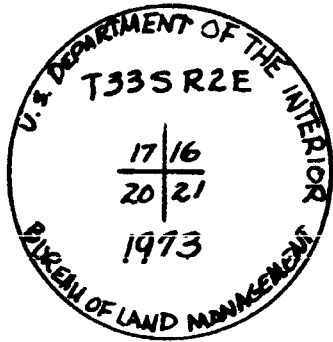

Sketch

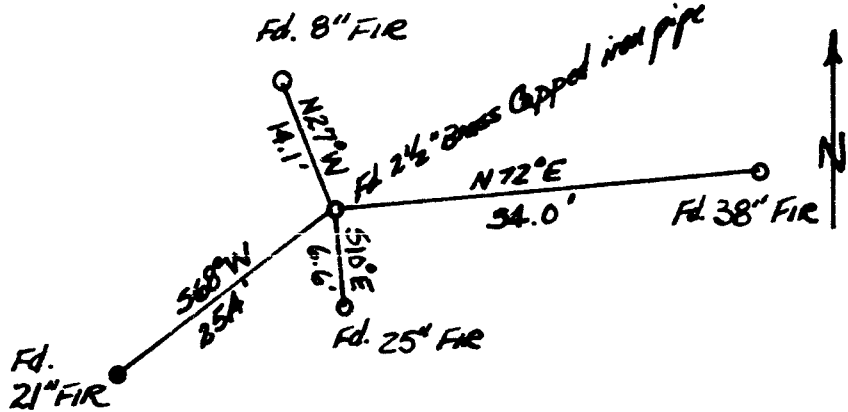

Monument Set (Procedures and Description)

New Accessories

Location & Comments

Stewart State Park Compass Declination 20 1/2° E
All bearings and distances by hand compass and steel tape. Drawing not to scale. Firm/Agency Oregon State Parks & Recreation Div.
 Address 525 Trade St. SE Salem OR 97310
 Party Chief Craig Holt
 Notes Craig Holt
 Witness G.Cottrell, B.Staggs

Surveyor's Seal

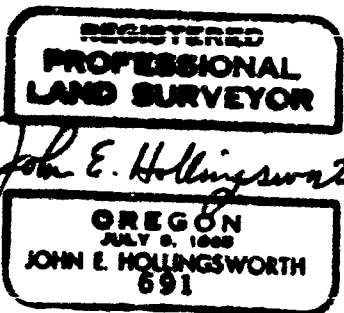

OREGON CORNER RESTORATION FORM

Section 20 Township 33S Range 2E

County Jackson Date 11/4/83

Corner Designation

Section Corner

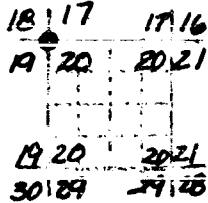

- Condition Report Only
- Not Found
- Renewed
- Unrecorded
- Surveyed In
- Referenced Out

Previous Renewals/Surveys, etc. GLO Resurvey 1933

Jackson Co. Surveyor File 77-9, Hoffbuhr, Bath and Assoc., Inc. 1983

Monument(s) & Accessories Found: (Condition and Source)

Found 2 1/2" brass cap on iron pipe with another 2" diameter iron pipe along-side. Both pipes 0.8' above ground.

Found 24" diameter pine S82°E, 56.1', scribing unintelligible.

Found 23" diameter black oak, S70°E, 56.1', with rotted blaze.

Found 20" diameter fir, S38°E, 35.1', blaze visible.

Found 9" diameter fir, S32°W, 38.4', with overgrown blazes.

Found 11" diameter fir, N20°W, 22.3', with overgrown blazes.

Found 9" diameter cedar, N27°E, 16.8', scribing unintelligible.

Monument Detail

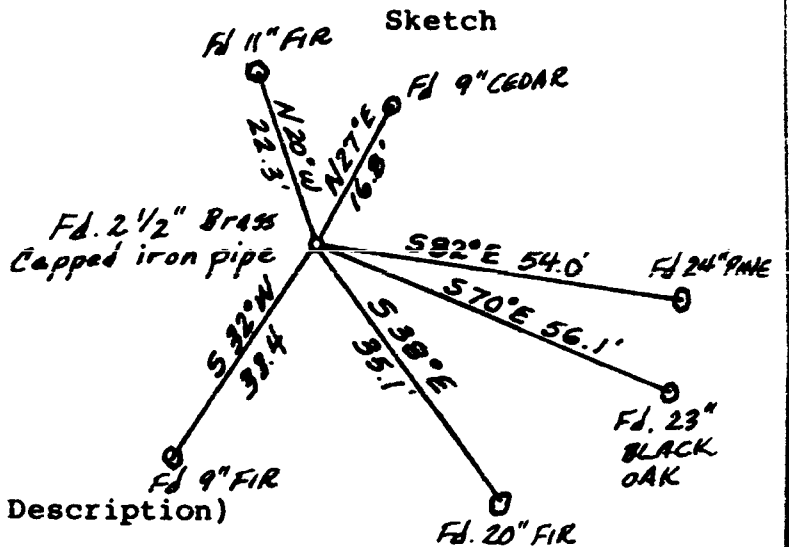
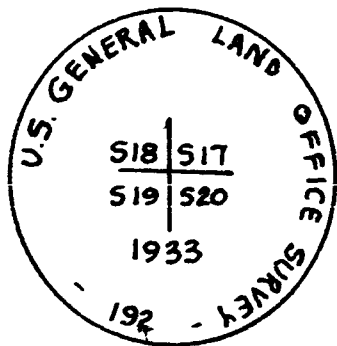

Monument Set (Procedures and Description)

New Accessories

Location & Comments

Stewart State Park Compass Declination 20 1/2° E

All bearings and distances Firm/Agency Oregon State
by hand compass and steel Parks & Recreation Div.
tape. Address 525 Trade St. SE
Drawing not to scale. Salem OR 97310

Party Chief Craig Holt

Notes Craig Holt

Witness B. Staggs

Surveyor's Seal

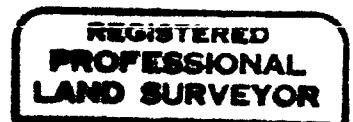

John E. Hollingsworth



OREGON STATE PARKS & RECREATION DIVISION SURVEY
 JOSEPH STEWART STATE PARK
 Sections 20, 29 and 30, T33S, R2E, W.M.
 Jackson County, Oregon
 December 21, 1984

NARRATIVE
 (See Accompanying Plat)

The purpose of this survey was to establish the boundary of Joseph Stewart State Park located in the southeast quarter of Section 20, the northwest quarter of Section 29, and the northeast quarter of Section 30 in Township 33 South, Range 2 East, Willamette Meridian.

The bearings are Oregon Grid South Zone. The bearing basis was from a survey by Hoffbuhr/Bath & Associates dated April 30, 1983, utilizing the control monuments "P.O.S.T. 10-B" and "P.O.S.T. 11-A." A theta angle of $1^{\circ}26'30''$ was calculated from the grid coordinates of "P.O.S.T. 10-B" for conversion to true bearings.

Control traverses were established using a Kern "K-1SE," one-minute theodolite and a Hewlett-Packard "HP3805" electronic distance measuring instrument.

The north quarter corner of Section 20 is located under water, a calculated position was proportioned to match the location with that of the Hoffbuhr/Bath survey. All other necessary corners to complete this survey were found and tied to control traverses.

Several random points were set along the park boundary in Section 30 and are not meant to be corners of aliquot parts of the section. Also the boundary lines of the park have been marked at frequent intervals with park boundary tags nailed to trees.

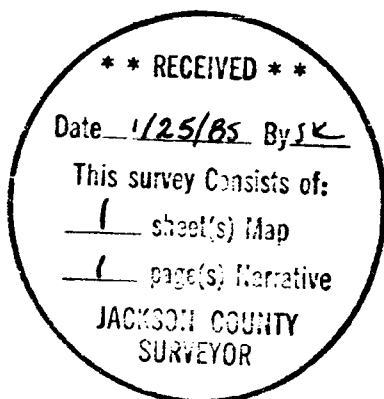

John E. Hollingsworth
 Oregon State Parks & Recreation Division
 525 Trade Street SE
 Salem, Oregon 97310