

BASIS OF BEARINGS: R.S. 7107

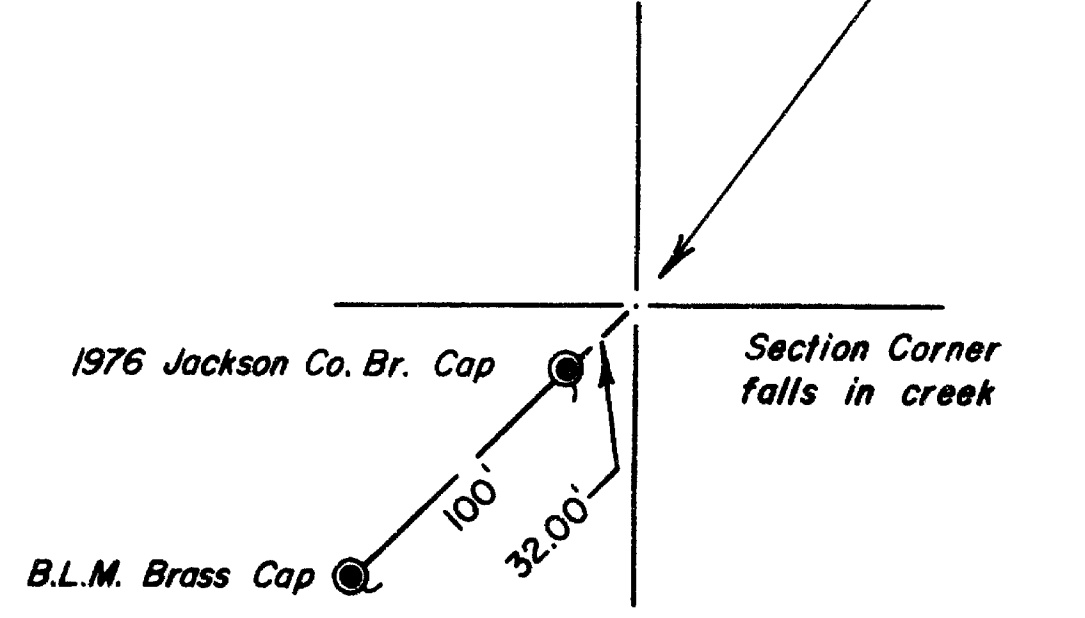

DETAIL SCALE: 1"=100'

** RECEIVED **
Date: 12/13/84 By SK
This survey consists of:
1 sheet(s) Map
1 page(s) Narrative
JACKSON COUNTY SURVEYOR

EDWARD'S SURVEYING
P.O. Box 604
Home River, OR 97037
Phone 582-3110

DETAIL SCALE: 1"=100'

REGISTERED PROFESSIONAL LAND SURVEYOR <i>Daniel W. Edwards</i> GREGON JULY 1971 DANIEL W. EDWARDS 741	SURVEY FOR: <i>Virgil Jenkins</i>	
	SCALE: 1"=1000' DATE: Oct. 26, 1984	() Record Measurement x-x-x Fence Line
LOCATION: In the NW 1/4 of Section 21, T. 34 S., R. 2 W., W.M. in Jackson County, Oregon		
● Monument found as noted ○ 5/8" x 24" steel pin set		DRAWING NUMBER

EDWARD'S SURVEYING
P. O. Box 801
Rogue River, OR 97537
Phone 582-3110

SURVEY NO. 10130

SURVEY NARRATIVE TO COMPLY WITH PARAGRAPH 209.250, OREGON REVISED STATUTES

SURVEY FOR: Virgil Jenkins
21891 Antioch Rd.
Central Point, Or. 97502

LOCATION: NW 1/4 of Section 21, T. 34 S., R. 2 W., W.M. in Jackson
County, Oregon.

PURPOSE: Locate fence and improvements in relation to East Line of
Northwest 1/4 of Northwest 1/4 of said Section 21.

PROCEDURE: Traversed between Government corners on perimeter of Section
21 as shown on accompanying plat. Subdivided the Northwest
1/4 of Section 21 on paper. Set 5/8" x 2 1/4" steel pins with
plastic caps stamped "DW EDWARDS-L.S. 741" attached as shown
on the accompanying plat.

EQUIPMENT: Lietz TM-20C theodolite and Lietz Red-1 E.D.M.

BASIS OF
BEARINGS: R.S. 7107

DATE
COMPLETED: October 26, 1984

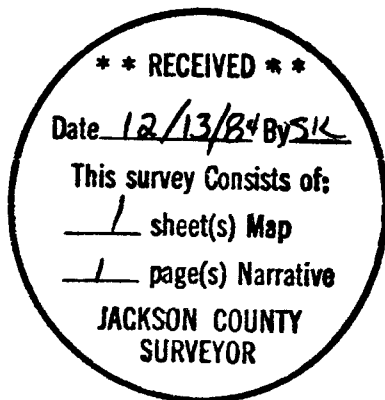

REGISTERED
PROFESSIONAL
LAND SURVEYOR

Darrel W. Edwards

OREGON
JULY 8, 1966
DARREL W. EDWARDS
741