

Survey in Lot 4 Block 3 Rogue Valley Heights Extension  
Jackson County, Oregon.

For Mr. Harvey Gwin, 223 1/2 Roberts Road.

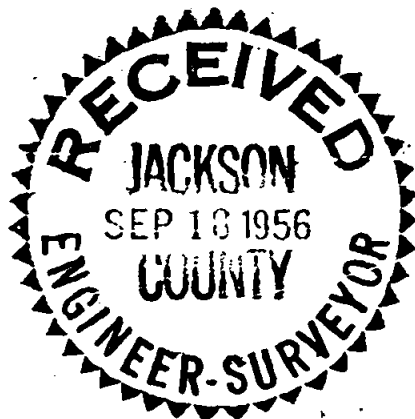

GARY ST

ROBERTS ROAD

N89°53'55"W 453.09

3/4" pipe found

5/8" bar found  
N.W. Cor. L 4 B 3

NE. Cor. L 4 B 3

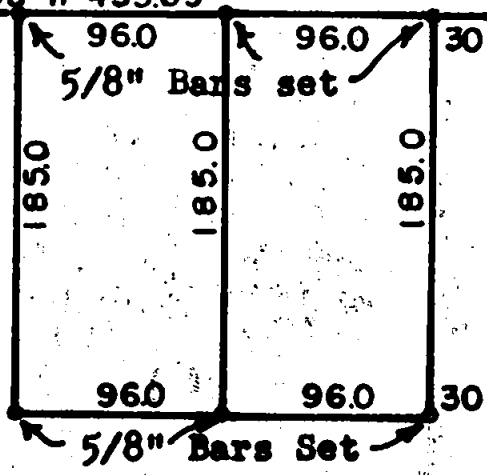

REGISTERED  
OREGON  
LAND SURVEYOR

*L. N. Dow*

MAY 6, 1949.  
L. N. DOW  
251

LOT 4 BLOCK 3  
ROGUE VALLEY HEIGHTS EXTENSION

S0°01'55"E 623.34 (plat)



Scale 1" = 100'

3/4" pipe found  
SE. Cor. L 4 B 3

Written narrative to accompany plat for survey No. \_\_\_\_\_

Survey for Mr. Harvey Gwin, 223<sup>1</sup>/<sub>4</sub> Roberts Road.

Location in Lot 4 Block 3 Rogue Valley Heights Extension  
*Sec. 17, T. 37S., R. 1W.*  
 Jackson County, Oregon.

Date August 18, 1956.

Procedure; Found 5/8" bar at the northwest corner of Lot 4, Found 3/4" pipe at the northeast corner of Lot 4, found 3/4" pipe at the southeast corner of Lot 4,

Turned the angle at the northeast corner to check plat bearings and found them satisfactory. I then set 5/8 bars at the corners of the two small lots as shown on the plat.

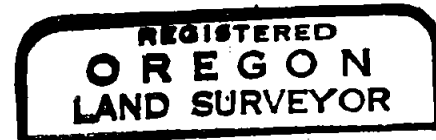

*L. N. Dow*  
 MAY 6, 1949  
 L. N. DOW  
 251

