

HILTON ROAD

3/4" pipe found N.W.cor. L12

3/4" pipe found SW.cor L12

348.00

Survey for Desmond L. Sweet  
In Sec. 18, T. 37, S, R. 1 W, (W.M) Jackson County, Oregon.  
April 11, 1954 Scale 1" = 50'

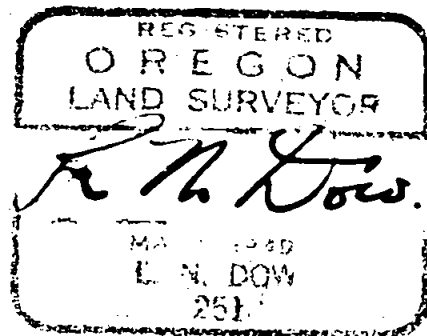

SE. Cor DLC No 38  
2" Pipe with plug & tack  
found

1" Square Oak stake  
beside cor. post  
found

12"x7' cor. post in way  
no pin set

found  
3/4" pipe  
SW.cor L15

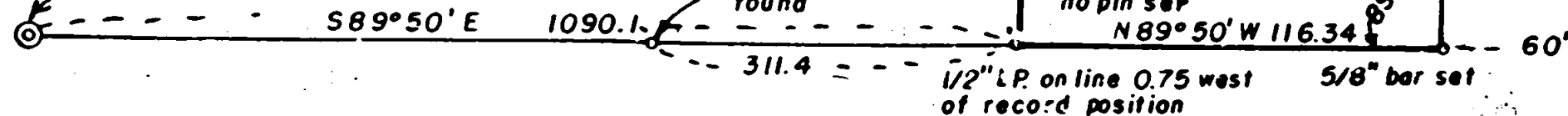

D. Rec. R70'  
Road Rec. R80'

60'

SCR-SUK

BULLOCK ROAD

ROGUE VALLEY HEIGHTS

Record N0°05'E 1044.00 (not chained for this survey)

1/2" L.P. on line 0.75 west  
of record position 5/8" bar set

Written narrative to accompany plat for survey No. 618  
as specified by Oregon Law.

Survey for Desmond L. Sweet, Medford, Oregon.

Location in Section 18, T. 37 S. R 1 W. (W.M.) Jackson County.

Purpose to stake out parcel and provide description.

PROCEDURE:

Found a 2" Iron Pipe with plug and tack at the Southeast corner of D.L.C. NO. 38 and ran  $S89^{\circ}50'E$  along the D.L.C. line 1090.1 feet to an iron pipe in the fence corner, said iron pipe being 0.75 foot west of the true location as recorded in the deed the true point being in the center of a 12" round by 7 foot high fence corner post, No point was set for this corner as the fence post prohibited that; then ran  $E89^{\circ}50'E$  116.34 feet to an intersection with the west Right of Way line of Bullock Road, said west right of way being 60 feet west and parallel to the westerly line of Rogue Valley Heights Subdivision; then ran  $N0^{\circ}05'E$  parallel to and 60 feet distant from the westerly line of of Rogue Valley Heights 138.0 feet and set a  $5/8"$  Iron Bar; then ran  $N89^{\circ}50'W$  116.34 feet and set a  $5/8"$  Bar in the fence line; then ran  $N0^{\circ}05'E$  71.0 feet and set a  $5/8"$  Bar; then  $S89^{\circ}50'E$  116.34 feet to the west line of Bullock Road and set a  $5/8"$  bar then ran  $S0^{\circ}05'W$  71.0 feet to close the tract being surveyed, as shown on the accompanying plat.

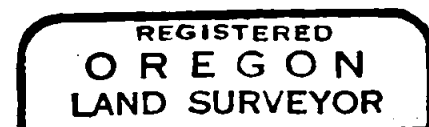
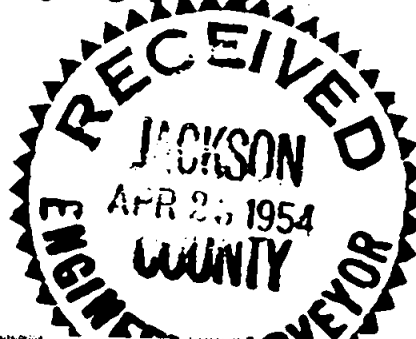

*L. N. Dow*

