

526

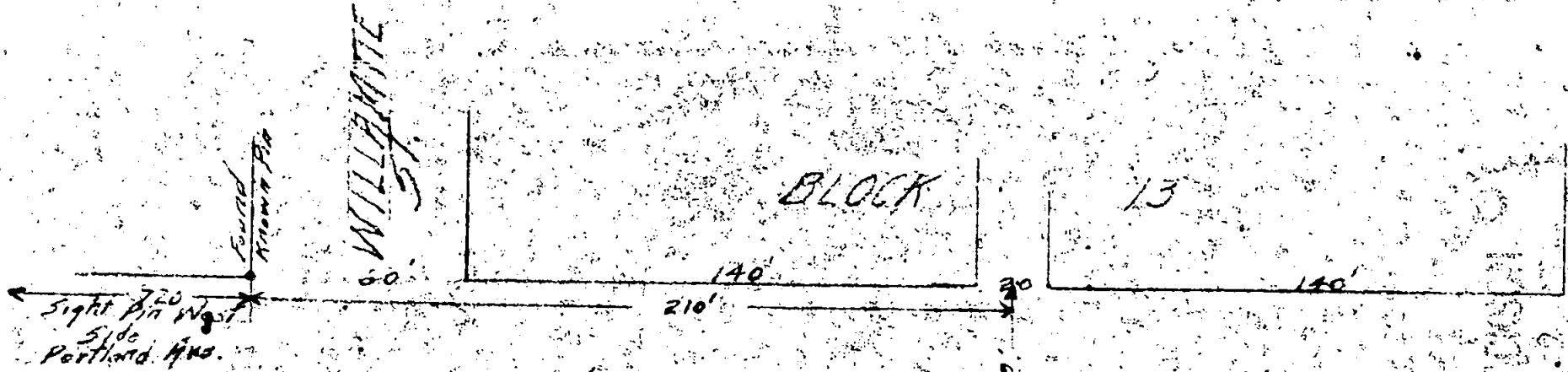

SURVEY
PORTION BLOCK 12
IMPERIAL ADDITION
 Medford, Oregon
 Jan 26, 1923
 Scale 1" = 50'

Hugh C. Ingle
 Civil Engineer



NARRATIVE REPORT

Survey for R. E. Marsh

Portion of Block 12, Imperial Addition

Purpose of the survey was for establishing corners of portion of Block 12, of Imperial Addition to City of Medford and to split the portion in two pieces.

Procedure:-

Pipes were found at Southwest corners of Portland avenue and Willamette street intersections with East 11th street. These were established by city survey in 1946. The distance between them checked exactly with record.

Line East on north side of 11th street was established from these and record distances run East and South to establish boundaries of survey. Lines were found to check South fence boundary and existing improvements and corner post at Southeast corner of subdivision.

