

• = Set 5/8" Iron Pin

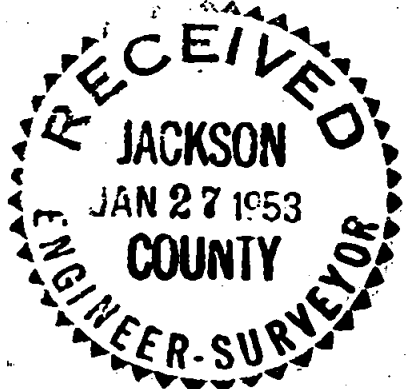

BOUNDARY LOCATION
 PROPERTY SITUATE IN
 Sec. 32, Twp. 36 S., R. 1 W. W.M.
 JACKSON CO., OREGON.
 J. H. CLABBY CIVIL ENGINEER
 MEDFORD, OREGON. SEPT. 15, 1952.
 SCALE 1" = 50'

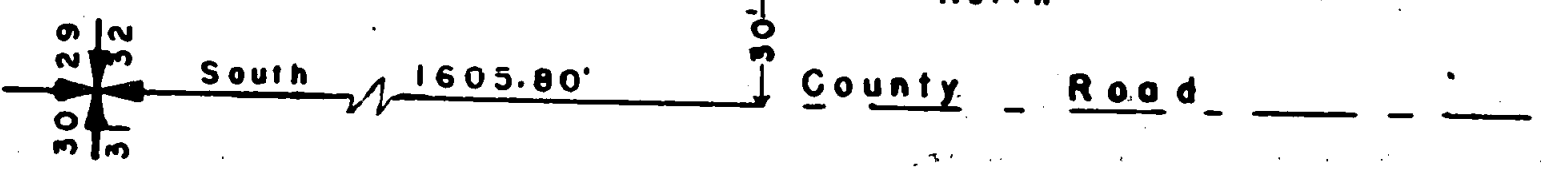

Survey Narrative to Comply with Section 87-330, 1947 Oregon State Laws.

Survey for: Warren C. Bayliss

Location: Section 32, Township 36 South, Range 1 West, W.M., Jackson County, Oregon.

Purpose of Survey:

To survey a parcel of land, one acre in area, situate in Lot 15 of the American Orchard Tracts.

Procedure: The plat of the American Orchard Tracts shows point of beginning and the Quarter (1/4) corner common to Sections 31 and 32. This corner could not be found. The Northwest and Southwest corners were located and the chained distance between was found to be 5303.60 feet. The Quarter (1/4) corner was taken as the midway point 2651.80 feet South from the Northwest corner of Section 32.

The record distance from Quarter (1/4) corner to the Northwest corner of Lot 15 is 1162.20 feet or 1489.60 feet South and 30.00 feet East from said Northwest corner of Section 32.

From Northwest corner of Lot 15 ran South 116.22 feet for the true point of beginning, thence continue South 116.22 feet, thence East 375.20 feet, thence North 116.22 feet, thence West 375.20 feet to the point of beginning.

J. H. Clabby



September 1952

