

For Narrative, see Volume 1, Page 240

MAP OF PORTION OF F.M. LITTLE PROPERTY
SECTION 15, TOWNSHIP 35 NORTH, RANGE 4 WEST
WILLAMETTE MERIDIAN
ROGUE RIVER, JACKSON COUNTY, OREGON

SCALE: 1" = 200'

NOV. 3, 1951

403

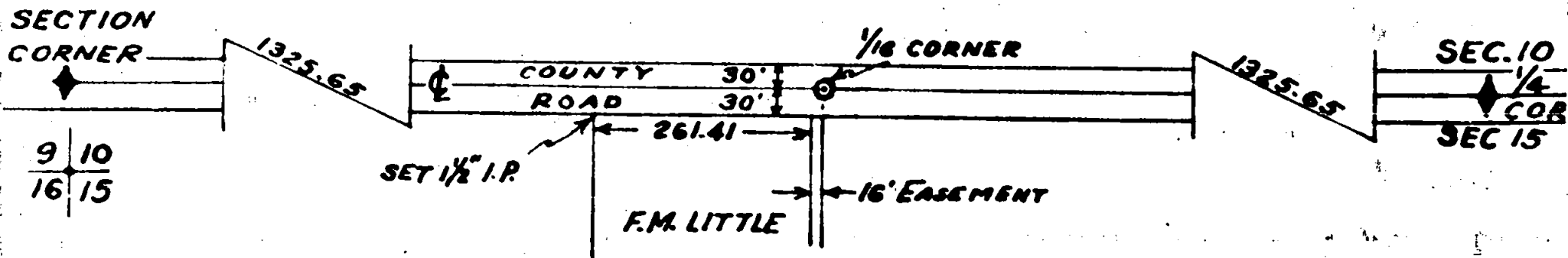

ENGINEER - JACKSON COUNTY, OREGON
 Dec. 1 1951
 JUN 11

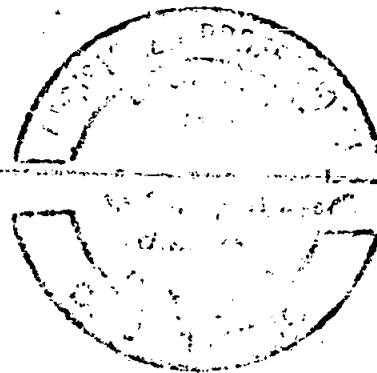

TIMBER CRUISING
APPRAISALS
TOPOGRAPHY

LOGGING ENGINEERS
O. & C. RIGHTS-OF-WAY
LAND SURVEYING AND MAPPING

Siskiyou Timber Service

ROOM 202

PHONE 3309

327 S.E. 6TH STREET
GRANTS PASS, OREGON

S.

✓ Section 15, T. 35 N., R. 4 W., Wm. Mer.
Jackson County
Survey of Portion of Little Property

I started this survey at the section corner of sections 9, 10, 15, and 16, T. 35 N., R. 4 W., W.M. which was an iron pipe 2" in diameter located near the centerline of the county road. I then located the quarter corner of sections 10 and 15 from the two bearing trees as given by the office of the county surveyor. I then ran along the section line of sections 10 and 15 and set a temporary 1/16 corner 1325.65 feet east of section corner of 9, 10, 15, and 16 from which the following old scribed trees bear:

16" Oak S 05° E 69.1 feet
12" Oak N 02° E 32.7 feet

I then ran west along the section line from this 1/16 corner 277.4 feet to a point on the centerline of the county road from which I turned a right angle to the section line, and set a 1½" iron pipe 30 feet to the south.

