

#325

S.E. Cor. D.L.C. No. 42
T 37 S, R. 1 W. (W.M)

Plot 135.0'

E. MAIN ST.
F.S. At & Willamette

367.00 P.I.D.

Found Orig. Mon. lying removed
on bank of alley

Set 3/4"x 30" I. Pipe

Conc. base of original Mon. found.
lead center gone, Top Mon. gone
Uncovering of this monument and
the setting of a 3/4"x 30" Iron pipe
with plug and tack to replace it
was witnessed by Mr. R.A. Skinner
of 1004 W. Main, Medford and
Mr. W.H. Jamison, 110 Portland Ave.

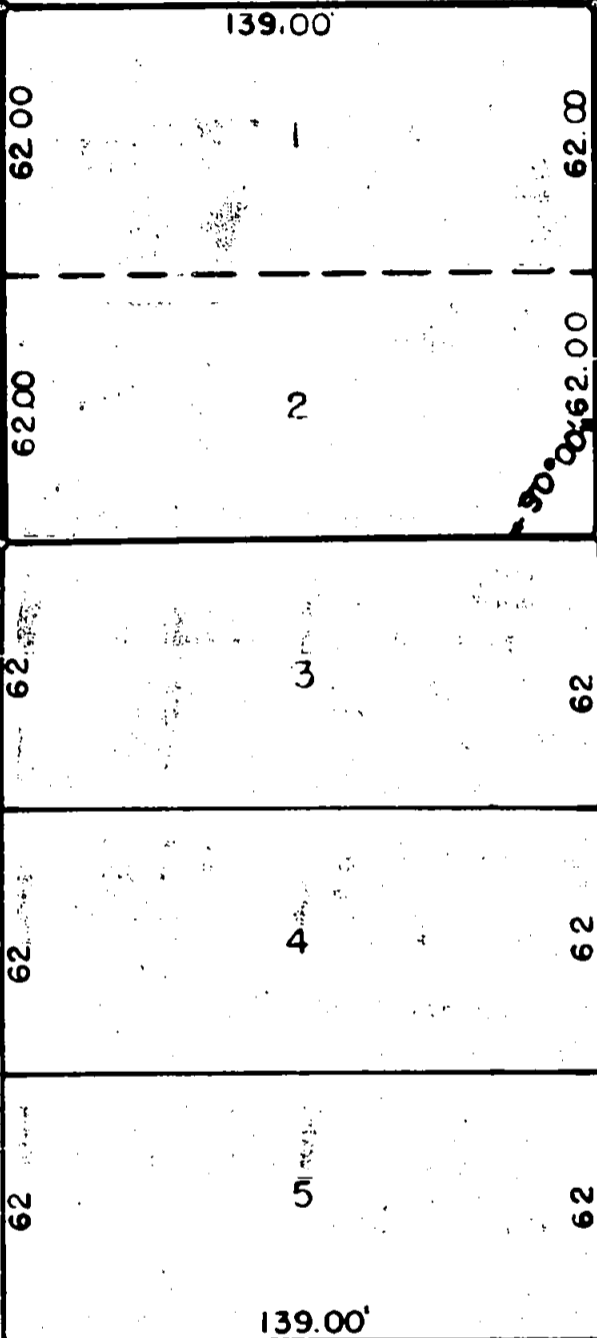

found 1" I. Pipe in conc.

Existing 1" I. Pipe set in conc.
found to be 0.18' north and 0.09' E
of correct position for this
survey

PORTLAND AVE

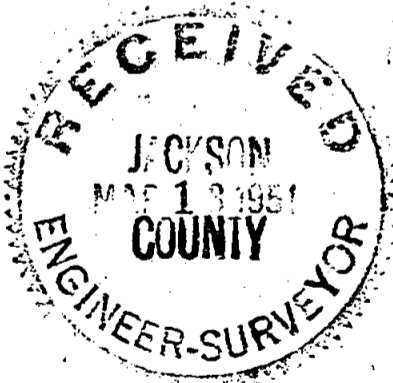

found Orig. Conc. Mon. with lead plug.

found Original Conc. Mon.
with lead plug.

SURVEY FOR MR. R.A. SKINNER
LOTS 1 & 2 CONSOLIDATED ADD NO. 2
TO CITY OF MEDFORD, OREGON.
SURVEY MADE FEB. 24, 1951.

REGISTERED
OREGON
LAND SURVEYOR

L. N. Dow

MAY 6, 1949
L. N. DOW
251

325

325

Written narrative to accompany plat for Survey No.
as specified by Oregon Law.

Purpose of Survey, to recover or restake the north corners to Lot 1, and the south corners of Lot 2, Consolidated Addition No 2 to the City Of Medford, Oregon.

For Mr. R.A. Skinner, 1004 E Main St. Medford, Oregon.

Date of Survey Feb. 24, 1951.

Procedure, A 1" Iron Pipe set in concrete was found at the Southeast corner of Lot 2, and from this pipe the base of the original monument was uncovered at the Northeast corner of Lot 2, The top of this monument has been broken off along with the lead center, The concrete monument at the northwest corner of lot 2 was found to lying on the ground near the point where it should have been planted. Next the monuments were found intact and in good shape at the south end of this subdivision. It was then necessary to run from East along East Main Street from the Southeast corner of D.L.C. no 42 the plat distance of 135.0 feet to check the location of the the existing pipes at the south side of lot 2 for accuracy. Following this a 3/4" x 30" Iron Pipe was set at the location of the broken monument at the Northeast corner of Lot 1. The setting of this pipe and the uncovering of the original monument was witnessed by Mr. R.A. Skinner, 1004 E. Main and By Mr. W.H. Jamison, of 110 Portland Avenue.

Following this the Northwest corner of lot 1 was replaced by setting a 3/4" x 30" Iron pipe monument at the location of the original monument as shown on the accompanying plat.

