

SURVEY NARRATIVE TO COMPLY WITH SECTION 87-330,  
1947 Oregon State Law.

247

Survey No. 247

For: Medford Labor Temple Association

Purpose of Survey: To establish the boundaries of the property including Lots 15, 16, 17, & 18, of Block No. 54 of the original town of Medford.

Procedure:

Using the street monuments on Grape St. and Holly St. at their intersection with 6th and 9th streets for control of the center line of Grape and Holly Streets and the center line of West Main St. and 8th St. as established by previous surveys, then established the intersections of the streets enclosing Block No. 54. Then determined the distances along the boundaries of Block No. 54 and established the boundaries of the above stated property on a proportion of basis between record and measured distances. Set iron pins at the East, West, and South corners of said property. The North corner was marked with a reference corner; a lead point in the concrete walk on the property line extended one foot into Grape Street.

May - 1950

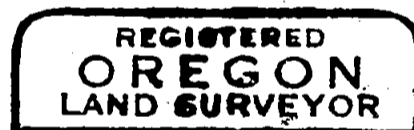

*C. Z. Boyden*

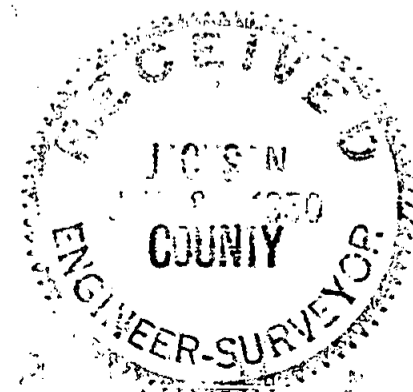
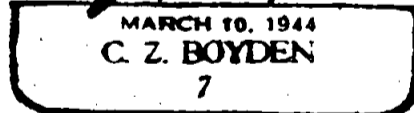

REGISTERED  
OREGON  
LAND SURVEYOR

*C. Z. Boyden*

MARCH 10, 1944  
C. Z. BOYDEN  
7

MEDFORD LABOR TEMPLE  
LOTS 15, 16, 17 & 18, OF BLOCK 54  
MEDFORD (ORIG. TOWN)  
MAY 10, 1950

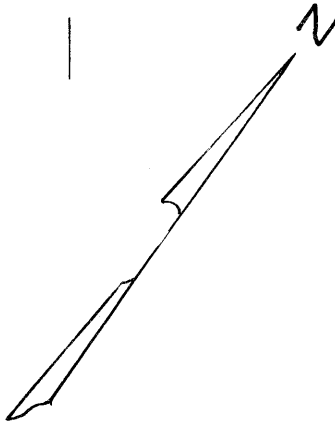

SCALE: 1" = 100  
◎ IRON PIN IN CASE  
◦ IRON PIN SET  
◦ LEAD POINT IN CONG. WALK

