

PLAT SHOWING A SURVEY
 DONE FOR **MR. RALPH L. COOK.**

PROPERTY LOCATED IN D.L.C. No 40, TWP. 37 S.,
 RANGE 1 WEST OF THE WILLAMETTE MER.

JACKSON COUNTY OREGON.

SCALE 1" = 60.0'

OCT. 20., 1949

J.A. HOFFBUHR, REGISTERED LAND
 SURVEYOR.

1234.11 S., 984.77 E., OF
 S.E. COR. OF DLC #39

N 89° 13' 20" W 148.97
 LINE 4

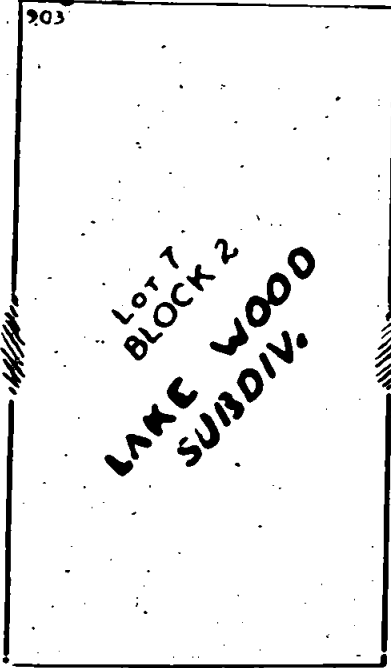

OREGON
 LAID SURVEYOR
J.A. Hoffbuhr
 NOVEMBER 7, 1941
 J. A. HOFFBUHR
 222

NOTE: BEARINGS DERIVED BY SOLAR OBS.

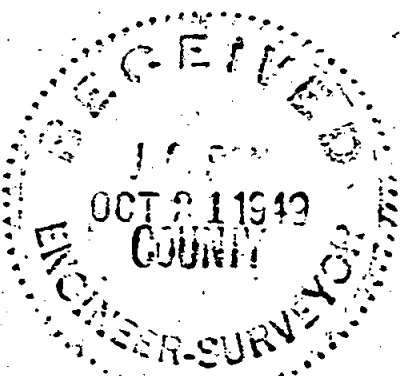

Survey No. 204 Survey Narrative to Comply with Section 87-330
1947 Oregon State Laws.

204

Survey for; Mr. Ralph L. Cook,

Location of Survey;

Tract located in D. L. C. No. 40, Township 37 South,
Range 1 West of the Willamette Meridian, Jackson Co.
Oregon.

Purpose of Survey;

To survey and describe said tract being a portion of tract
described in Jackson Co. Deed Record Vol. 243, page 156,
and bounded on the East and North by the Rogue River Valley
Irrigation District Canal and the West by the tract desc.
in Jackson Co. D. R. Vol 237, page 466, and on the South
by the Lake Wood Subdivision.

Survey Procedure;

Bearings were established by Solar Observation. Beginning at the
Southeast corner of Donation Land Claim No. 39, T., 37 S., Range 1 West
of the Willamette Mer. and running South 1234.11 feet and East 984.77
feet to a point on the North line of the said subdivision, and said
point bearing S 89° 13' 20" E 9.03 feet of the Northwest corner of Lot
7, Block 2, of said subdivision, and set a 1" iron pipe, said pipe
bears 3.56 feet South and 3.14 feet East of a 3/4" iron bolt found
and presumably set for the southeast corner of the said tract desc.
in D.R. Vol. 237, page 466, thence N 47° 37' 30" W 351.59 feet and set
a 3/4" pipe, thence N 28° 57' W 220.48 feet to intersect the center line
of the R.R. Irrig. Dist. Canal, thence along the center line of the
said canal S 76° 23' E 207.50', thence N 73° 18' E 247.90 ft., thence
S 41° 13' 30" E 180.82 ft., thence S. 64° 42' 50" E 66.45 ft., thence
S 26° 05' 30" E. 62.39 feet, thence S 34° 15' 50" W 250.55 feet, thence
S 16° 23' 10" W 54.91 feet to intersect the North line of the said
Subdivision 53.00 feet S 89° 13' 20" E from the Northeast corner of
said lot 7, Block 2, of said Subdivision, thence along said subdivision
line N 89° 13' 20" W 148.97 feet to the point of beginning.

J. A. Hoffbuhr,
Registered Land Surveyor.



J. A. Hoffbuhr

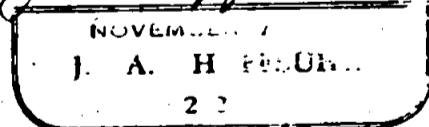

Oct. 20, 1949

