

REGISTERED
OREGON
LAND SURVEYOR

C. Z. Boyden

MARCH 10, 1944
C. Z. BOYDEN
7

SURVEY FOR
W. A. WHITELAW

LOT NO. 1 BLOCK NO. 2 OF PALM SECOND ADD.

APRIL 1949

SCALE 1 IN. = 30 FT.

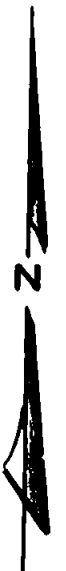

D.L.C. Line

N 0° 02' E

90° 00'

592.2

S 89° 58' E 180.2

OHIO ST.

90° 00'

25.2

60.2

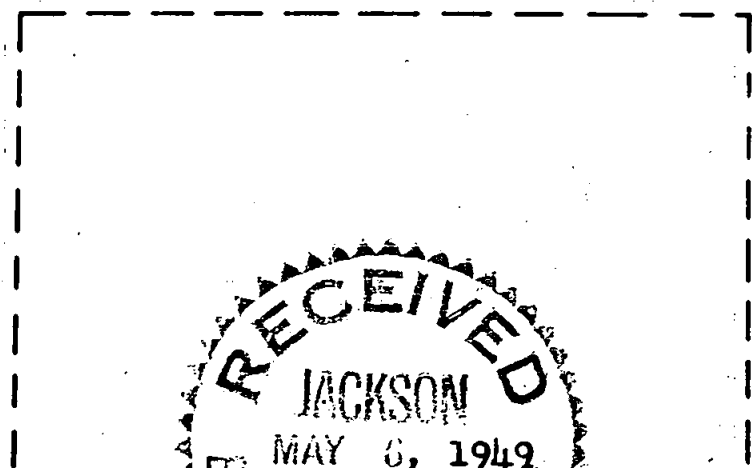

RECEIVED
JACKSON
MAY 6, 1949
COUNTY
ENGINEER-SURVEYOR

BOARDMAN ST.

N 0° 02' E

37.2

1/2" IRON PIPE

S 89° 58' E 100.2

90° 00'

1" G.I. PIPE

S 0° 02' W

37.2

N 89° 58' E 100.2

1/4" IRON PIPE

FD. 3/4" IRON PIN

2

137

S.W. Cor. D.L.C. No. 61
T 37 S R 2 W

137

*Messford*Narrative Survey No. 137

For: W. A. Whitelaw

Purpose of Survey: To locate and monument boundaries of Lot No. 1, Block No. 2 of Palm Second Addition.

Began at the S.W. corner of D.L.C. No. 61, Township 37 South, Range 2 West and ran N. $0^{\circ} 02'$ E. along the West boundary of said D.L.C. 592.0 feet; thence S. $89^{\circ} 58'$ E. 180.0 feet to the intersection of the East line of Boardman Street with the center line of Ohio Street; then ran S. $0^{\circ} 02'$ W. 25.0 feet and found a small iron pin at the Northwest corner of said Lot No. 1; continued S. $0^{\circ} 02'$ W. along the East boundary of Boardman Street and found a 2" x 2" wood lot stake at the S.W. corner of Lot No. 3.

Returned to the N.W. corner of Lot No. 1 and continued to stake the lot being S. $89^{\circ} 58'$ E. 100.0 feet, S. $0^{\circ} 02'$ W. 37.0 feet, N. $89^{\circ} 58'$ W. 100.0 feet, and N. $0^{\circ} 02'$ E. 37.0 feet.

Also found a $3/4$ " iron pin at the Southeast corner which checked O.K. for corner. Set iron pipes stamped with a No. "7" at other corners as indicated on the map to accompany this report.

April 29, 1949

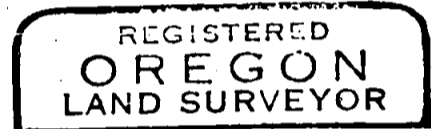
*C. Z. Boyden*