

LAUREL ST. — N0°26' W

8TH ST.

SEE SURVEY N^o 98

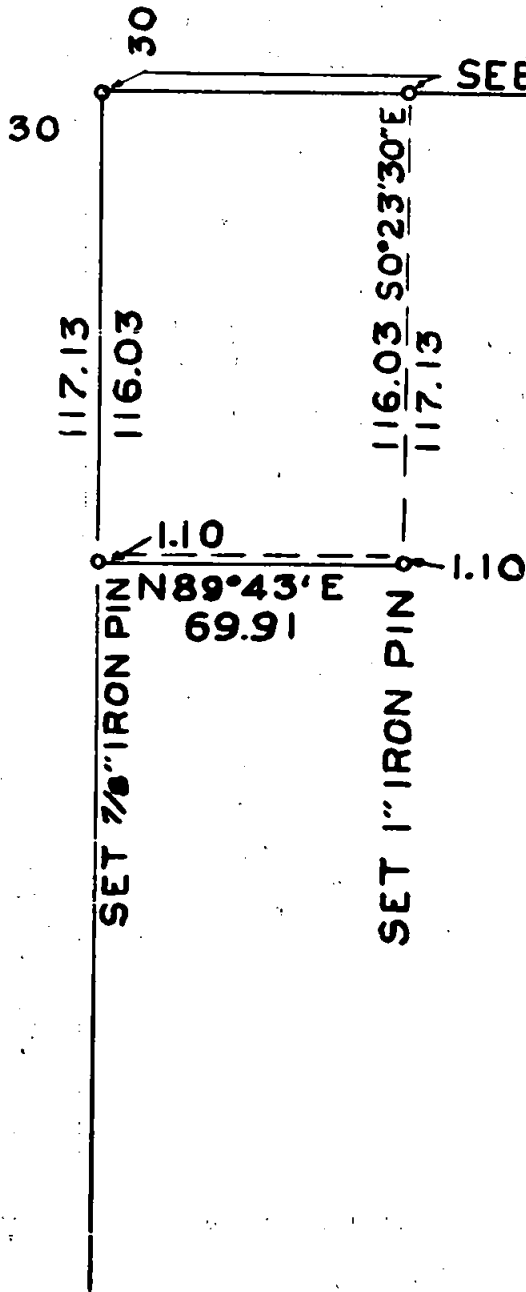

J.H. CLABBY

IN BLOCK N^o 4 GALLOWAY'S ADD.

SURVEYED

NOV. 18, 1948

113

REGISTERED
OREGON
LAND SURVEYOR

C. Z. Boyden

MARCH 10, 1944
C. Z. BOYDEN
7



SCALE ÷ 1" = 50'

Jan. 6, 1949

JUN 11

Medford

Survey No. 113

For: J. H. Clabby

Purpose of Survey: To stake the Southeast and Southwest corners of a strip of land 1.10 feet in width to be added to the Southerly end of a tract of land located in Block No. 4 of Galloway's Addition to the City of Medford, said tract previously surveyed for Harriett E. Merritt and recorded in Records of Surveys in Jackson County Engineer's Office, survey No. 98.

Using the same controls as used for said Merritt survey No. 98, set a 7/8" iron pin on the Easterly boundary of Laurel Street 1.10 feet S. 0° 26' E. from the Southwest corner of said Merritt tract and then ran N. 89° 43' E. parallel to and 1.10 feet Southerly from the Southerly boundary of said Merritt tract 69.91 feet and set a 1" iron pin at a point S. 0° 23' 30" E. 1.10 feet from the Southeast corner of said tract.

November 18, 1948

REGISTERED
OREGON
LAND SURVEYOR

C. Z. Boyden

MARCH 10, 1944
C. Z. BOYDEN
7

JAN 6 1949
ENGINEER SURVEYOR
JACKSON COUNTY

JAN 10 1949
ENGINEER SURVEYOR
JACKSON COUNTY