

LOT SURVEY for Mr. George Porter, Located in #33

BLOCK 7, QUEEN ANNE SUBDIVISION, TO MEDFORD OREGON

SCALE 1" = 100.0'

FEBRUARY 22, 1948

J.H. CLABBY, CONS. ENGR.

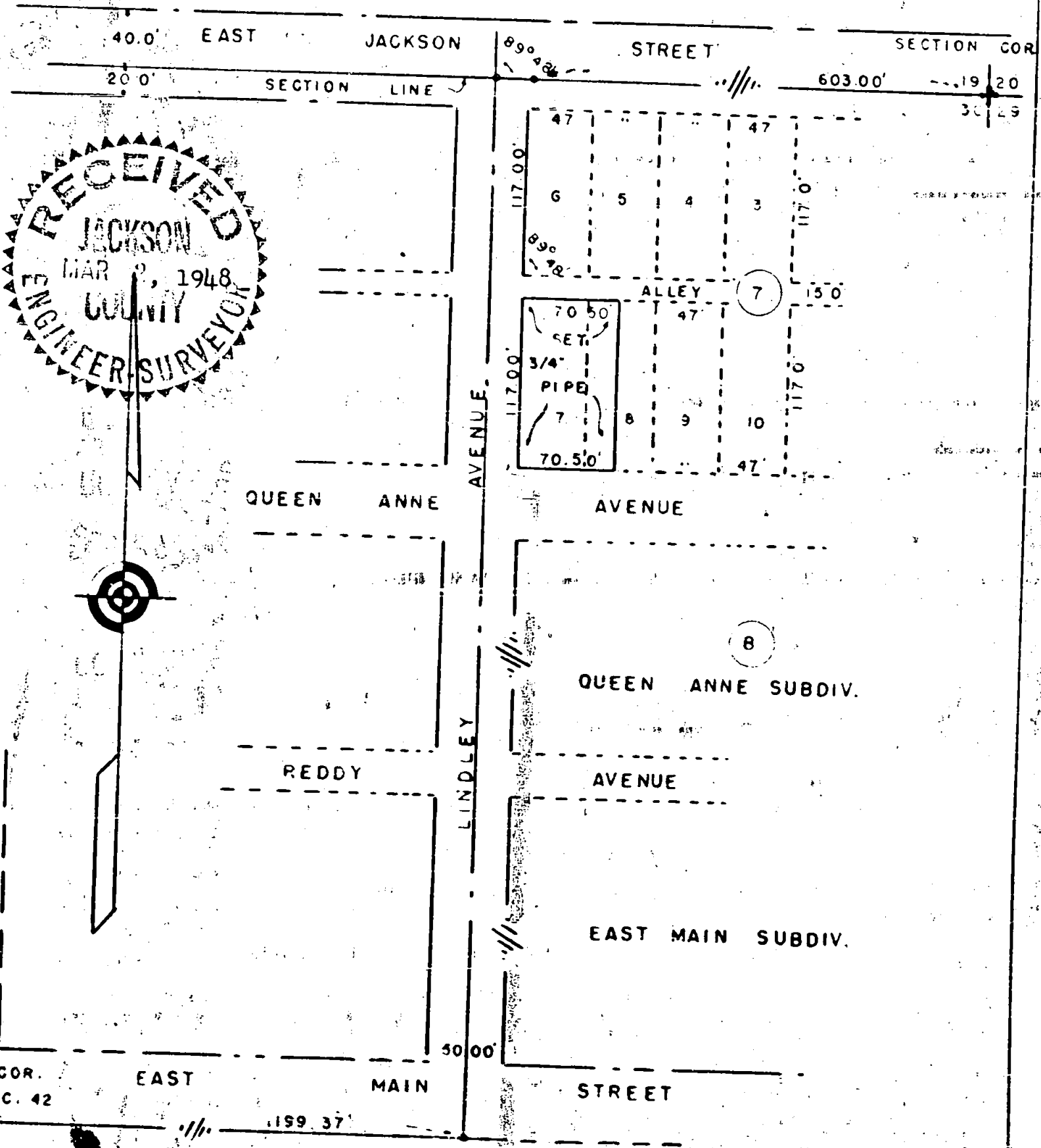

Survey Narrative to Comply with Section 87-330, 1947 Oregon Laws # 33

Survey for: Mr. George Porter, Queen Anne Avenue, Medford, Oregon

Purpose of Survey: To stake Lot 7 and the West  $\frac{1}{2}$  of Lot 8, Block 7, of the Queen Anne Subdivision

Commence at the Section corner common to Sections 19, 20, 29 and 30, Township 37 South, Range 1 West, Willamette Meridian, Jackson County, Oregon:

Run thence Westerly on the North line of Section 30, for a distance of 603.00 feet to the point of intersection of the Easterly boundary of Lindly Avenue projected:

Run thence Southerly along the Easterly boundary of Lindley Avenue 152.00 feet and set a 3/4" x 18" iron pipe for the Northwest corner of Lot 7:

Run thence Easterly parallel with the aforementioned section line 70.50 feet and set a 3/4" x 18" iron pipe for the Northeast corner of Lot:

Run thence Southerly parallel with Lindley Avenue 117.00 feet and set a 3/4" x 18" iron pipe for the Southeast corner of Lot:

Run thence Westerly parallel with the above mentioned section line 70.50 feet and set a 3/4" x 18" iron pipe for the Southwest corner of Lot 7, Block 7:

Run thence Northerly along the Easterly boundary of Lindley Avenue 117.00 feet to terminate traverse at the point of beginning.

J. H. Clabby

February 1948

